

(Return) Figure 3

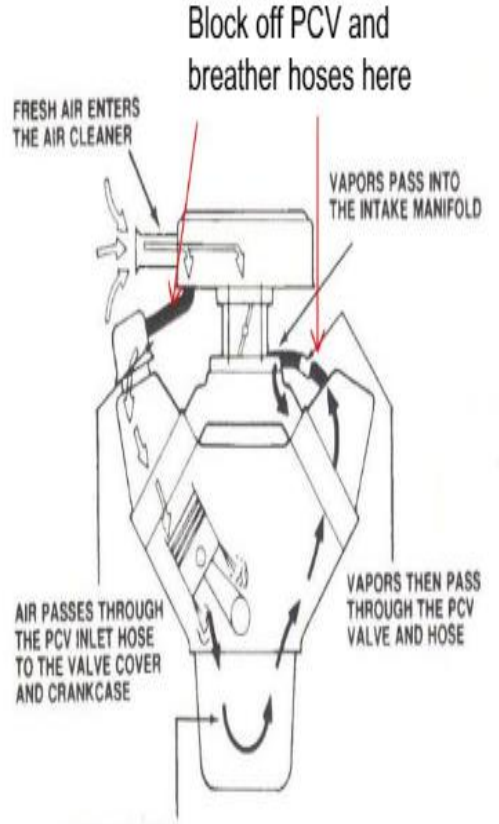

1997 Intrepid 3.5 with a P0305 DTC. Lean misfire caused by vacuum leak at #5 intake runner.

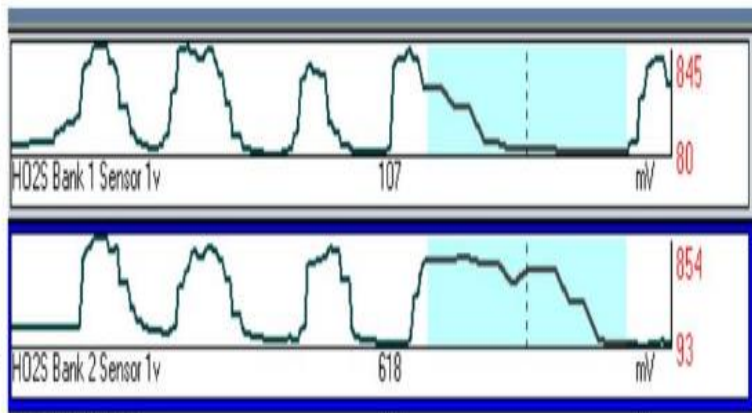
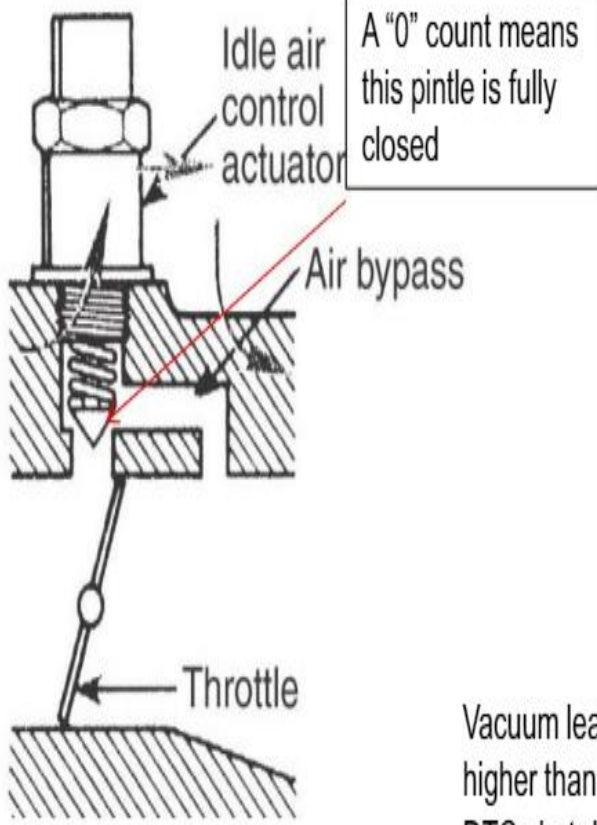

Short Term FT Bank 1	0.8	%
Short Term FT Bank 2	0.8	%
Long Term FT Bank 1	0.0	%
Long Term FT Bank 2	9.4	%
IAC Motor Position	0	crit
Engine Speed	902	rpm
Desired Idle Speed	640	rpm

Vacuum leak on bank 2, causing a 0 IAC count and an RPM that is higher than desired idle speed. This car had no lean exhaust DTCs but did have an idle adaptive limit code.