

2018 Mazda CX-5
BODY CONTROL SYSTEM (START STOP UNIT, FBCM, RBCM)

0940-1a

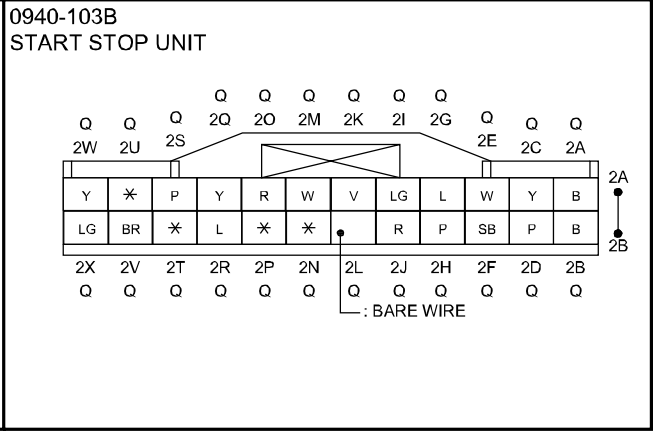
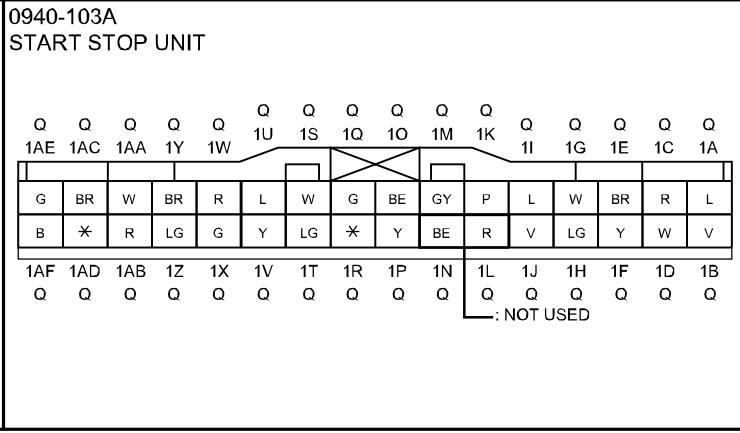
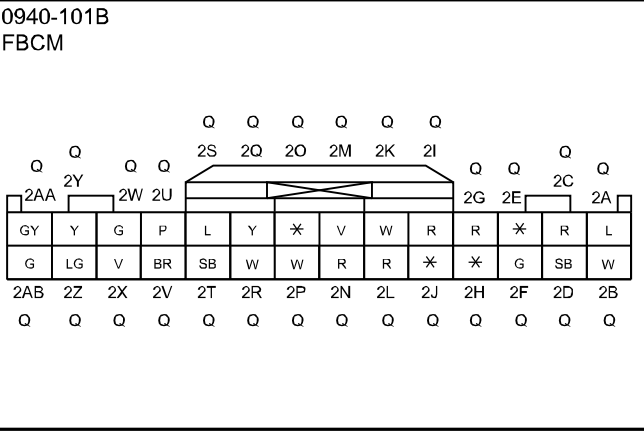

Front body control module (FBCM) terminal voltage table (reference)

Terminal	Measurement conditions	Voltage (V)
2A	Under any condition	B+
2M	Ignition switched ON (engine off)	B+
	Ignition switched OFF (LOCK)	1.0 or less
2U	Ignition switched ON (engine off)	B+
	Ignition switched OFF (LOCK)	1.0 or less

Start stop unit terminal voltage table (reference)

Terminal	Measurement conditions	Voltage (V)
1A	Under any condition	B+
1B	Ignition switched ON (engine off)	B+
	Ignition switched OFF (LOCK) or at ACC	1.0 or less
1E	Switch the ignition to ACC or ON (engine off)	B+
	Ignition switched OFF (LOCK)	1.0 or less
1Q	Because this terminal is for communication, integrity determination using terminal voltage inspection is not possible.	
1AF	Under any condition	1.0 or less
2B	Under any condition	1.0 or less
2D	Ignition switched ON (engine off)	B+
2W	Ignition switched OFF (LOCK) or at ACC	1.0 or less
	Under any condition	B+
2X	Under any condition	B+

2018 Mazda CX-5
 BODY CONTROL SYSTEM (START STOP UNIT, FBCM, RBCM)

0940-1a

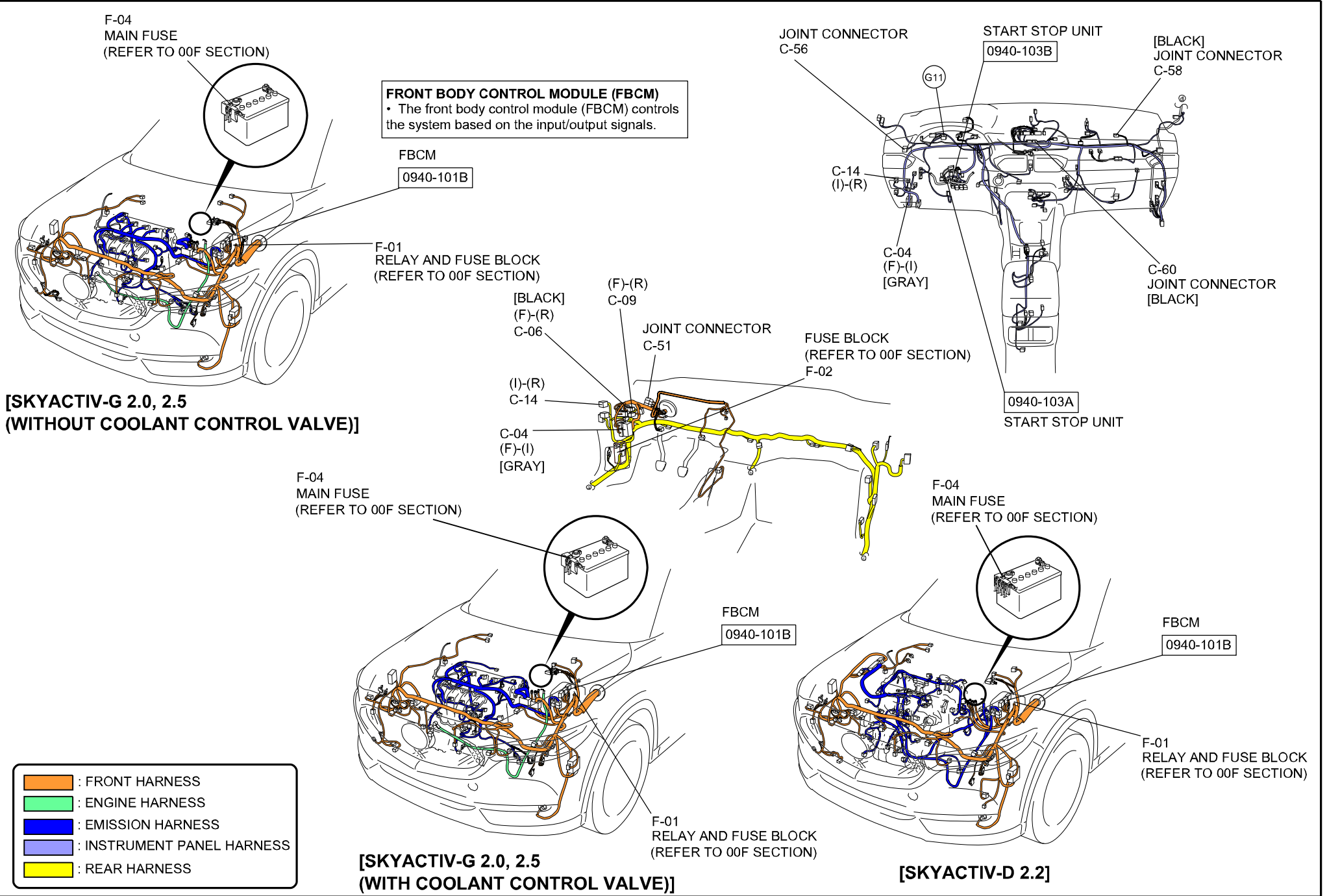

- : FRONT HARNESS
- : ENGINE HARNESS
- : EMISSION HARNESS
- : INSTRUMENT PANEL HARNESS
- : REAR HARNESS