

2019 Mazda MX-5 Miata L4-2.0L (SKYACTIV-G)

Vehicle > Engine, Cooling and Exhaust > Engine > Timing Components > Timing Chain > Service and Repair > Removal and Replacement

TIMING CHAIN REMOVAL/INSTALLATION

TIMING CHAIN REMOVAL/INSTALLATION [SKYACTIV-G 2.0]

SM1663972

id0110h280100t

Warning

- A hot engine can cause severe burns. Turn off the engine and wait until it is cool before servicing.

Caution

- If the camshaft is rotated with the timing chain removed and the piston at the top dead center position, the valve may contact the piston and the engine could be damaged. When rotating the camshaft with the timing chain removed, rotate it after lowering the piston from the top dead center position.
- When rotating the camshaft using a wrench on the cast hexagon, the wrench may contact the rocker arm and damage the rocker arm. To prevent damage to the rocker arm when holding the camshaft on the cast hexagon, use a wrench on the rear side of the engine as shown in the figure to secure a clearance between the cam.

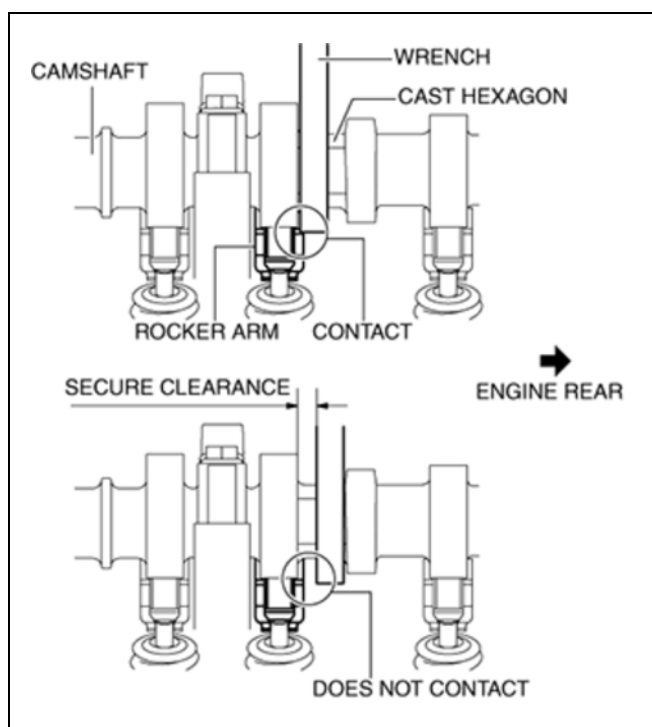

ac5wzw00003212

Note

- Width at the cast hexagon of the camshaft is 22–24 mm {0.87–0.94 in}.

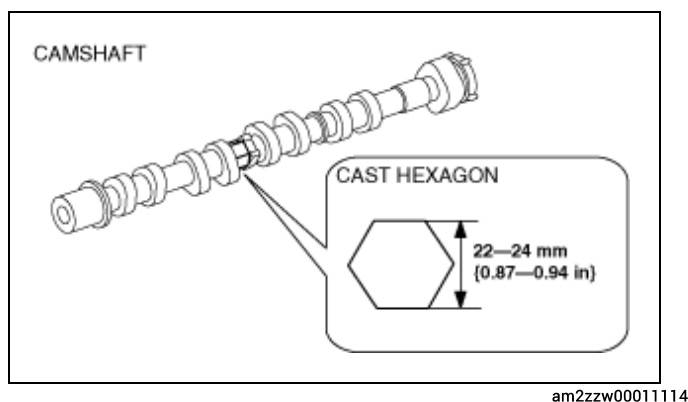

1. Disconnect the negative battery terminal. (See NEGATIVE BATTERY TERMINAL DISCONNECTION/CONNECTION .)
2. Remove the seal cover. (See SEAL COVER REMOVAL/INSTALLATION [SKYACTIV-G 2.0] .)
3. Remove the ignition coil/ion sensors. (See IGNITION COIL/ION SENSOR REMOVAL/INSTALLATION [SKYACTIV-G 2.0] .)
4. Remove the air cleaner, air hose and resonance chamber No.1 as a single unit. (See INTAKE-AIR SYSTEM REMOVAL/INSTALLATION [SKYACTIV-G 2.0] .)
5. Remove the drive belt. (See DRIVE BELT REMOVAL/INSTALLATION [SKYACTIV-G 2.0] .)
6. Remove the front crossmember under cover. (See FRONT CROSSMEMBER UNDER COVER REMOVAL/INSTALLATION .)
7. Drain the engine oil. (See ENGINE OIL REPLACEMENT [SKYACTIV-G 2.0] .)
8. Drain the engine coolant. (See ENGINE COOLANT REPLACEMENT [SKYACTIV-G 2.0] .)
9. Remove the oil pan. (See OIL PAN REMOVAL/INSTALLATION [SKYACTIV-G 2.0] .)
10. Remove in the order indicated in the table.
11. Install in the reverse order of removal.
12. Refill with the specified type and amount of the engine oil. (See ENGINE OIL REPLACEMENT [SKYACTIV-G 2.0] .)
13. Refill the engine coolant. (See ENGINE COOLANT REPLACEMENT [SKYACTIV-G 2.0] .)
14. Start the engine and inspect the following:
 - Leakage of engine oil and engine coolant.
 - Runout and contact of pulley and belt.
 - Ignition timing, idle speed and idle mixture. (See ENGINE TUNE-UP [SKYACTIV-G 2.0] .)

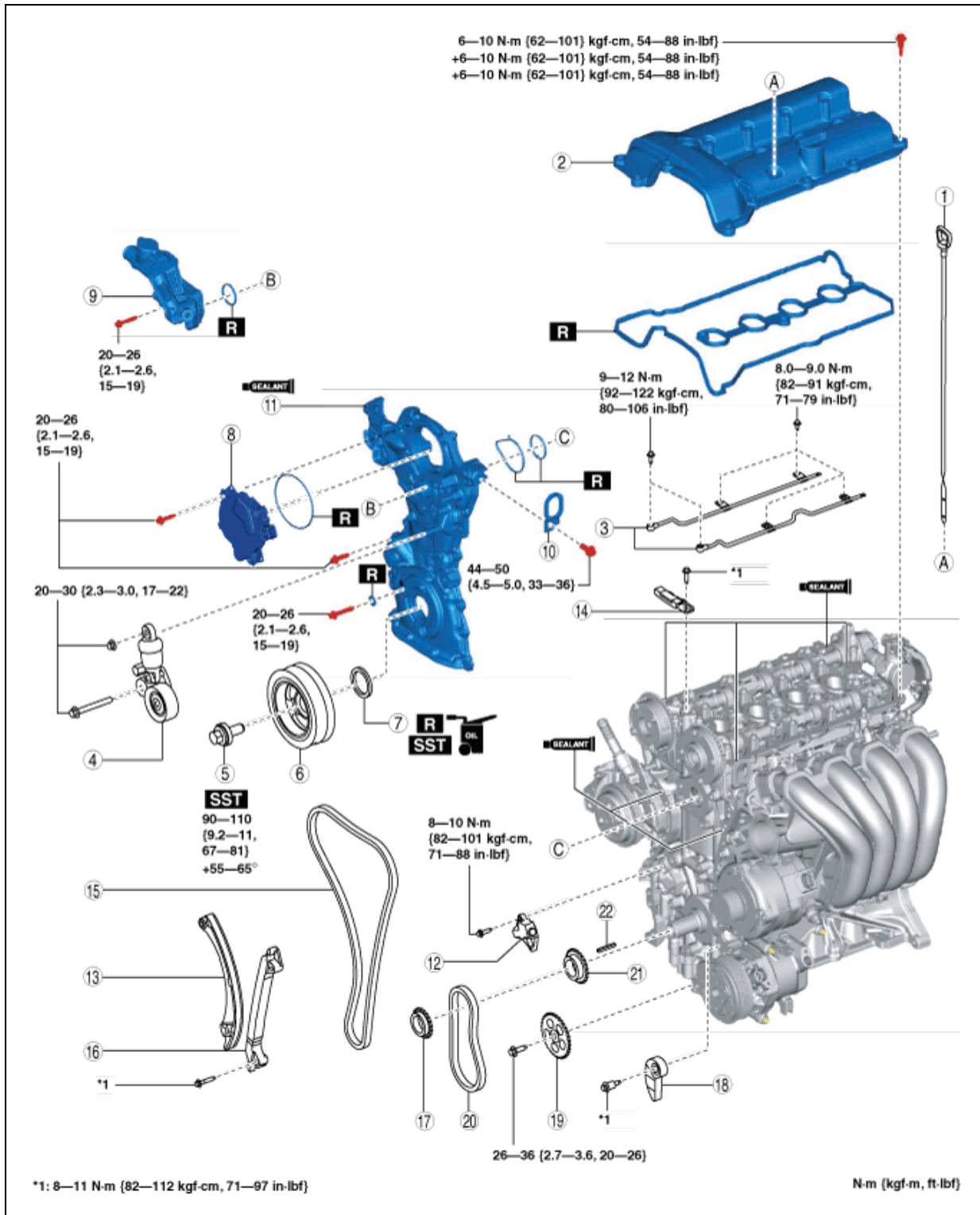

amxuuw0006708

1	Dipstick
2	Cylinder head cover (See Cylinder Head Cover Removal Note .) (See Cylinder Head Cover Installation Note .)
3	Oil shower pipe

4	Drive belt auto tensioner (See DRIVE BELT AUTO TENSIONER REMOVAL/INSTALLATION [SKYACTIV-G 2.0] .)
5	Crankshaft pulley lock bolt (See FRONT OIL SEAL REPLACEMENT [SKYACTIV-G 2.0] .)
6	Crankshaft pulley (See FRONT OIL SEAL REPLACEMENT [SKYACTIV-G 2.0] .)
7	Front oil seal (See FRONT OIL SEAL REPLACEMENT [SKYACTIV-G 2.0] .)
8	Electric variable valve timing motor/driver (See ELECTRIC VARIABLE VALVE TIMING MOTOR/DRIVER REMOVAL/INSTALLATION [SKYACTIV-G 2.0] .)
9	Water outlet component (See Water Outlet Component Removal Note .) (See Water Outlet Component Installation Note .)
10	Engine hanger
11	Engine front cover (See Engine Front Cover Removal Note .) (See Engine Front Cover Installation Note .)
12	Chain tensioner (See Timing Chain Removal Note .) (See Timing Chain Installation Note .)
13	Tensioner arm (See Timing Chain Removal Note .) (See Timing Chain Installation Note .)
14	Chain guide (No.1) (See Timing Chain Removal Note .) (See Timing Chain Installation Note .)
15	Timing chain (See Timing Chain Removal Note .) (See Timing Chain Installation Note .)
16	Chain guide (No.2)
17	Crankshaft sprocket
18	Oil pump chain tensioner
19	Oil pump driven sprocket (See Oil Pump Driven Sprocket Removal Note .) (See Oil Pump Driven Sprocket Installation Note .)
20	Oil pump chain
21	Oil pump drive sprocket
22	Key

Cylinder Head Cover Removal Note

1. Disconnect the OCV connector.
2. Remove the wiring harness clip secured to the intake manifold as shown in the figure, and set the wiring harness aside.

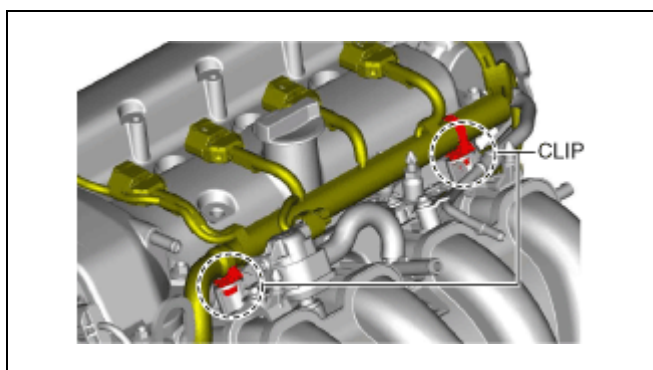

amxuuw00004389

3. Disconnect the ventilation hose.
4. Remove the cylinder head cover.

Water Outlet Component Removal Note

1. Disconnect the upper radiator hose.

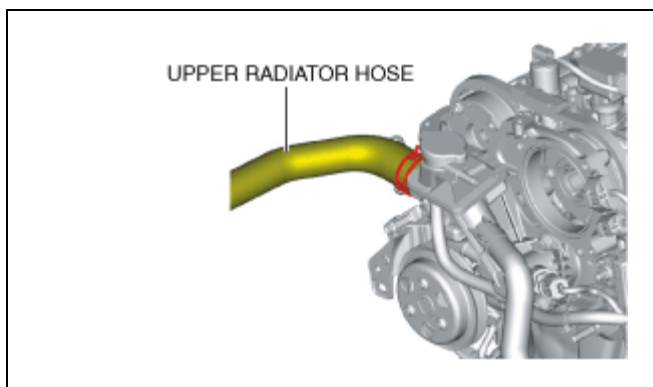

amxuuw00004392

2. Disconnect the heater hose.

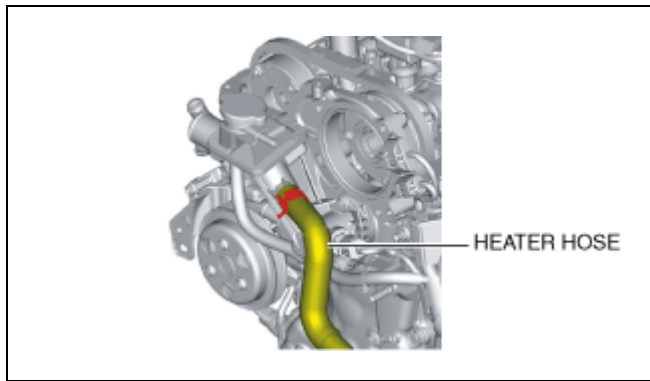

amxuuw0004393

3. Set the engine coolant temperature sensor No.1 wiring harness aside using the following procedure:

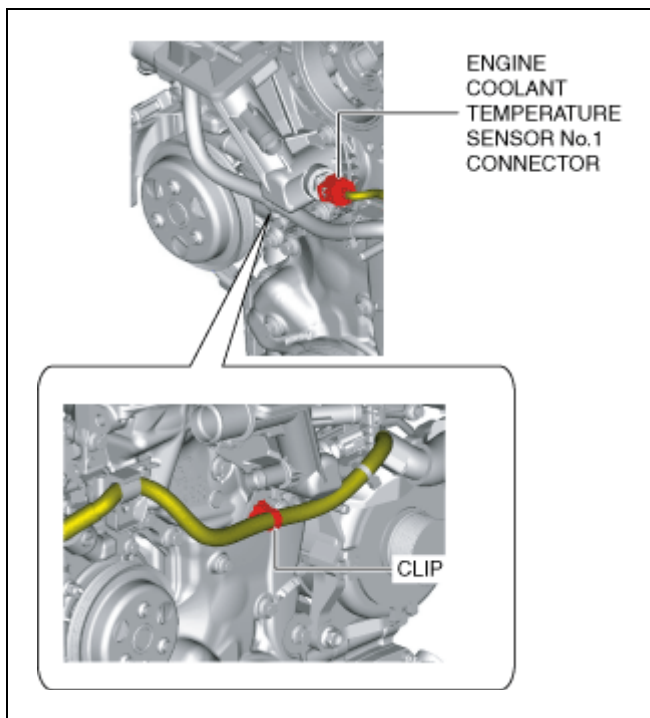

amxuuw0005407

(1) Disconnect the engine coolant temperature sensor No.1 connector.

(2) Remove the clip and set the wiring harness aside.

4. Remove the water outlet component.

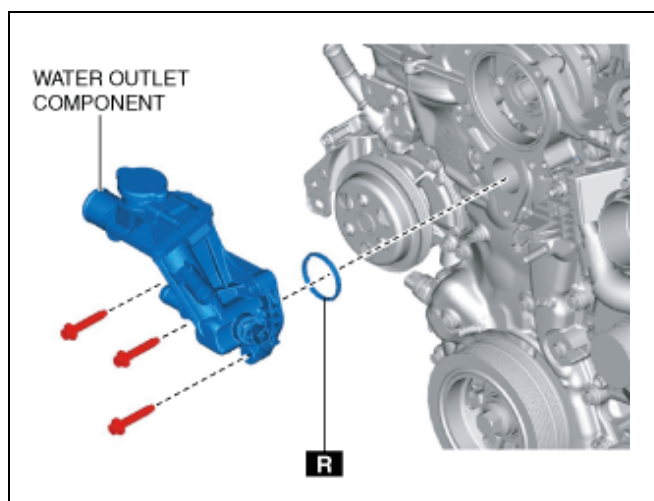

amxuuw00004395

Engine Front Cover Removal Note

1. Set the engine wiring harness aside using the following procedure:

(1) Disconnect the purge solenoid valve connector. (See PURGE SOLENOID VALVE REMOVAL/INSTALLATION [SKYACTIV-G 2.0] .)

(2) Disconnect or remove the following parts.

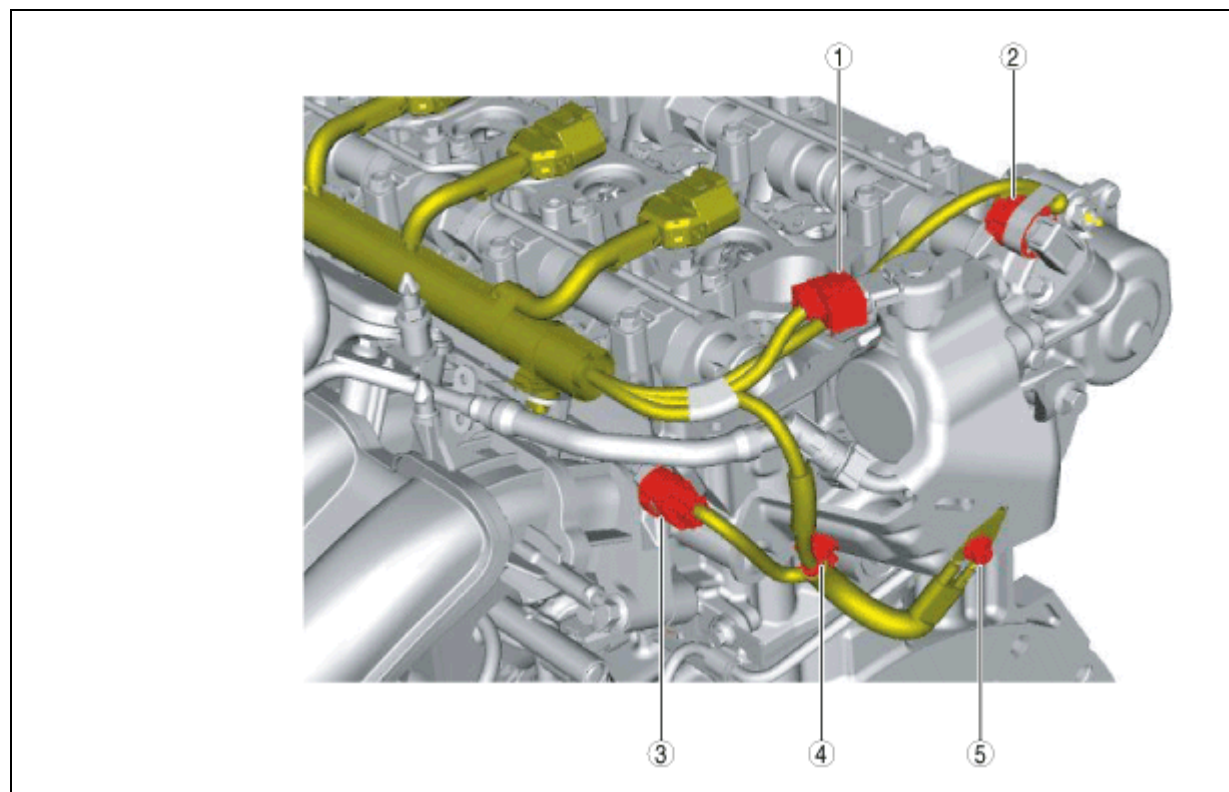

amxuuw00005632

1	High pressure fuel pump connector
2	Exhaust camshaft position sensor connector

3	Intake camshaft position sensor connector
4	Wiring harness clip
5	Bolt

(3) Remove the throttle body. (See INTAKE-AIR SYSTEM REMOVAL/INSTALLATION [SKYACTIV-G 2.0] .)

(4) Disconnect or remove the following parts.

Step 1

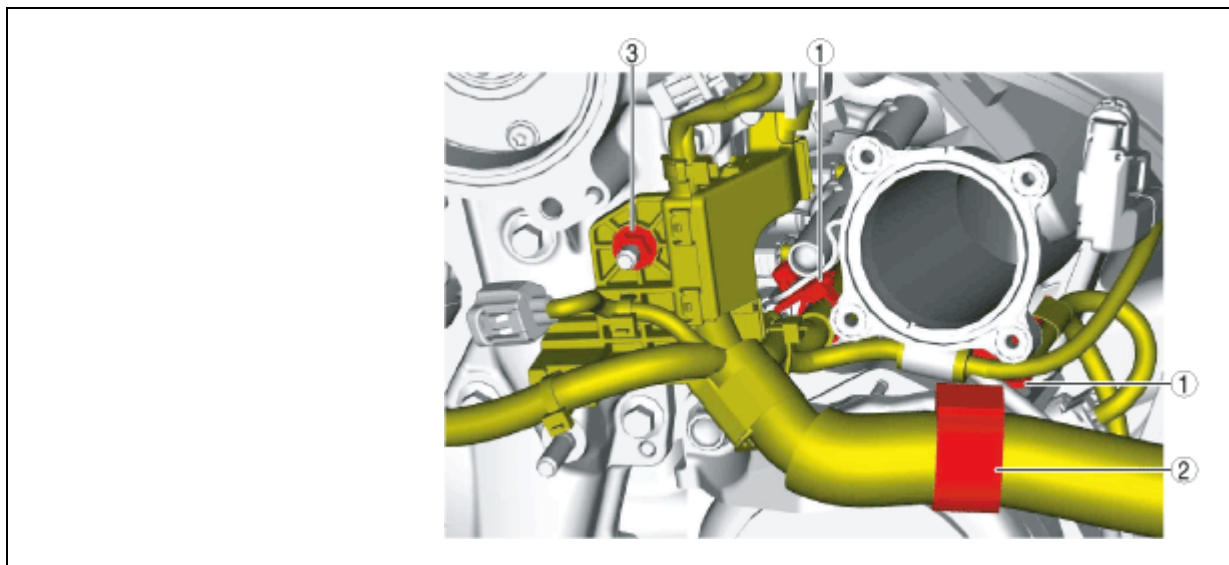

amxuuw00005633

1	Wiring harness clip
2	Wiring harness clip
3	Wiring harness protector installation nut

Step 2

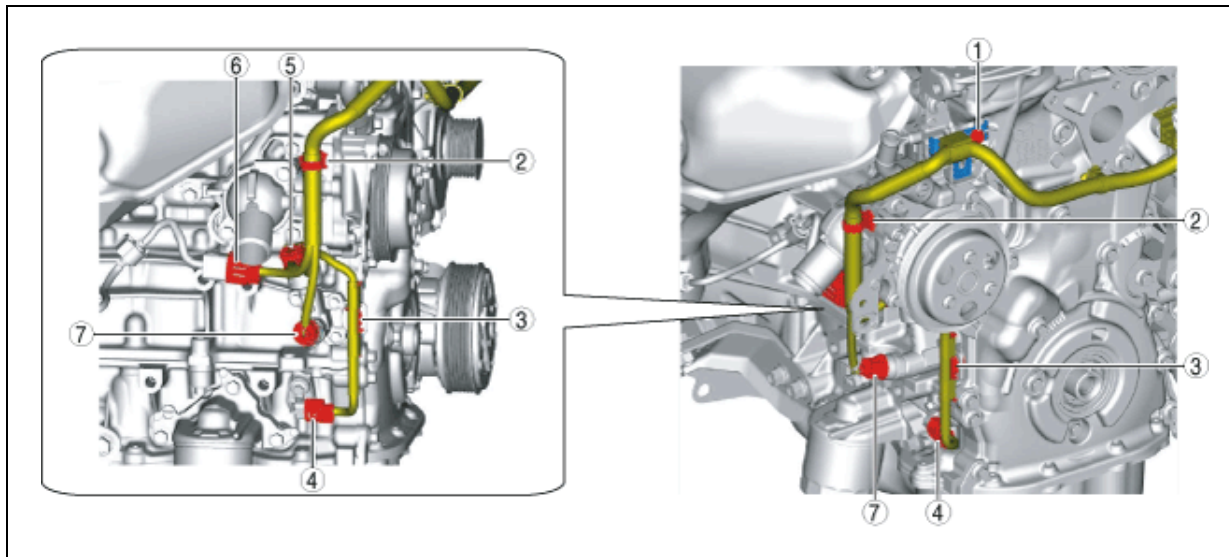

amxuuw0005634

1	Bolt
2	Wiring harness clip
3	Wiring harness clip
4	Crankshaft position (CKP) sensor connector
5	Engine oil solenoid valve connector
6	A/F sensor connector
7	Oil pressure switch connector

Note

- Remove the wiring harness clip next to the water pump by inserting a flathead screwdriver into the hole next to the water pump pulley as shown in the figure.

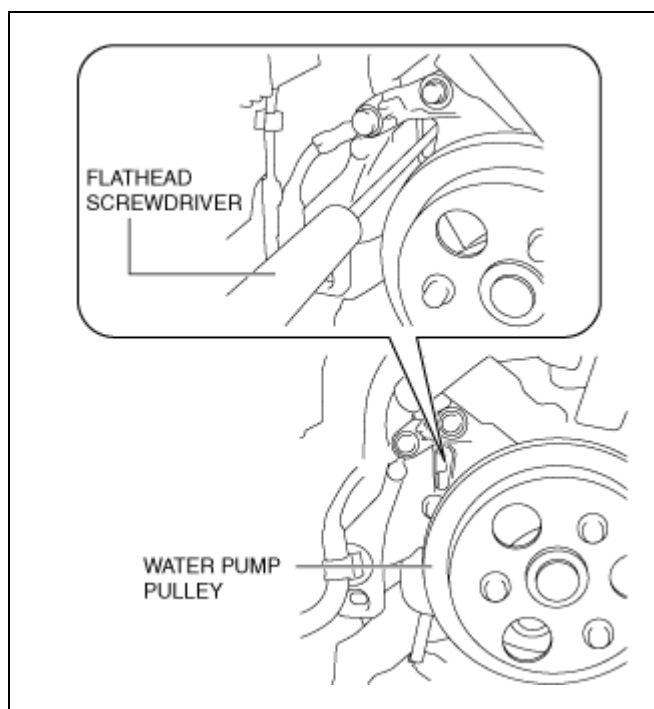

amxuuw00004399

(5) Set the engine wiring harness in a place which does not interfere with the servicing.

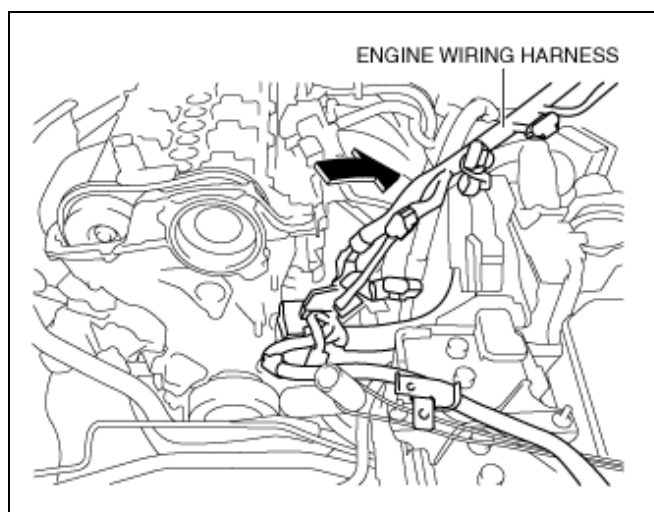

amxuuw00004400

2. Remove the engine front cover installation bolts.

3. Using a screwdriver wrapped in a cloth, peel the silicone sealant away a little at a time, and remove the engine front cover.

Caution

- Do not apply excessive force to the screwdriver. Otherwise, the engine front cover could be damaged.
- Be careful not to scratch or damage the seal surface. Otherwise, it could cause oil leakage.

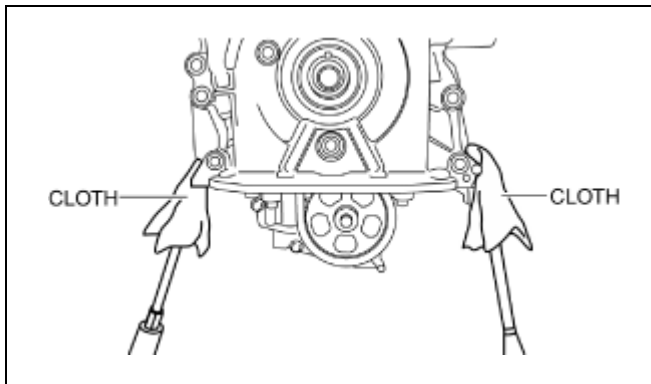

ac5wzw00003226

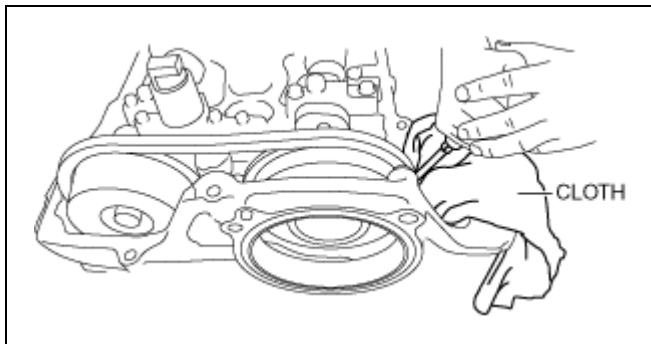

amxuuw00004401

Timing Chain Removal Note

1. Rotate the crankshaft clockwise to align the timing marks and the key position as shown in the figure, and set cylinder No.1 at top dead center (TDC).

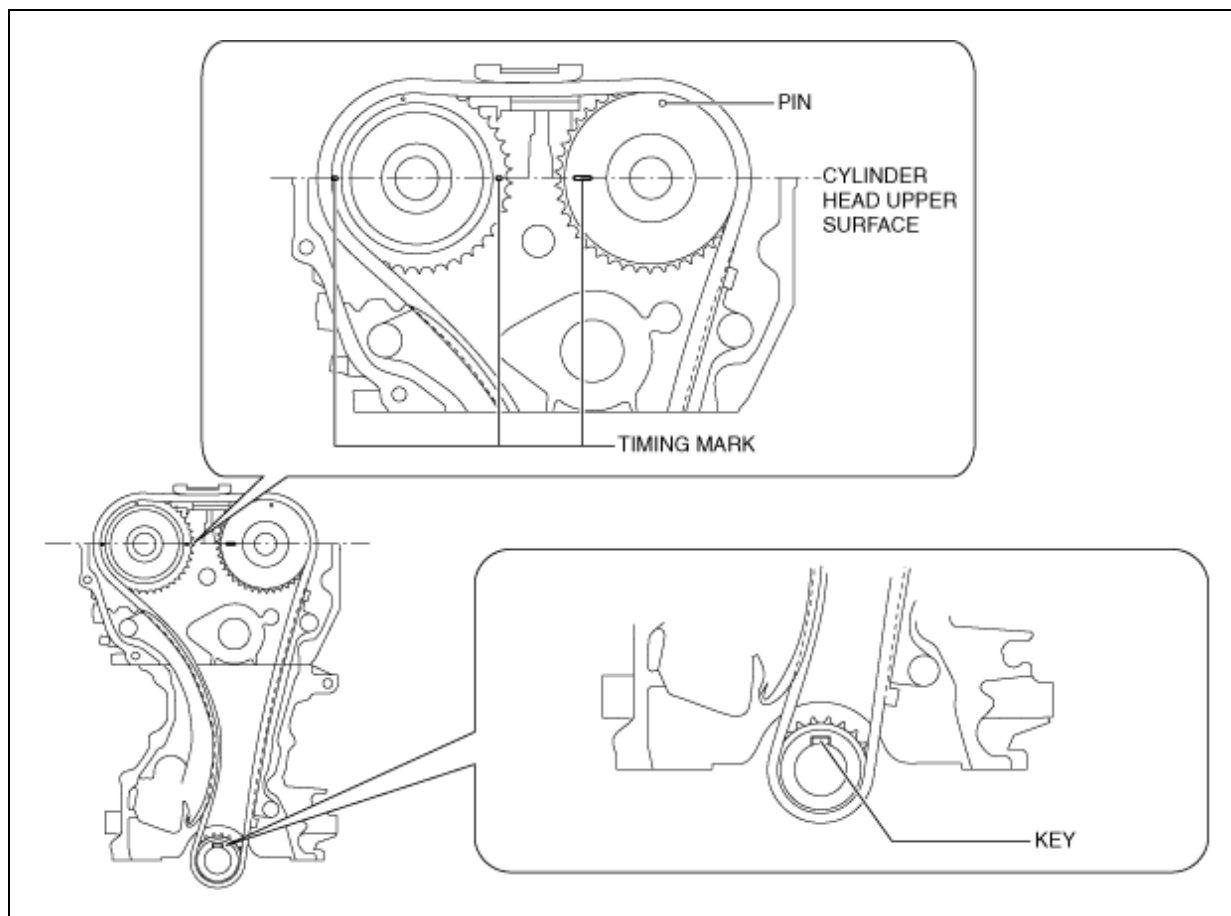

amxuuw0004403

2. Loosen the chain tensioner using the following procedure:

(1) Insert a metal rod (diameter approx. 1.4 mm {0.055 in} , length approx. 55 mm {2.2 in}) into the hole in the body of the chain tensioner.

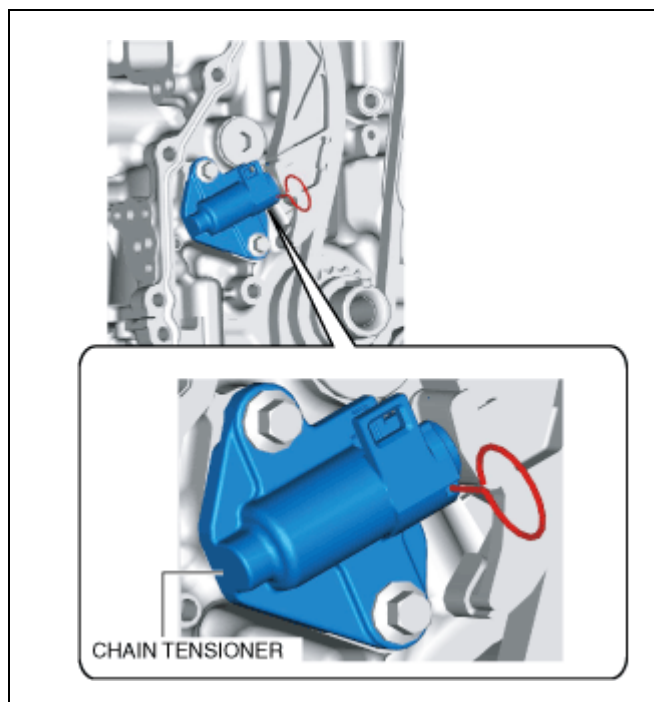

(2) Press the resister ring and unlock the plunger.

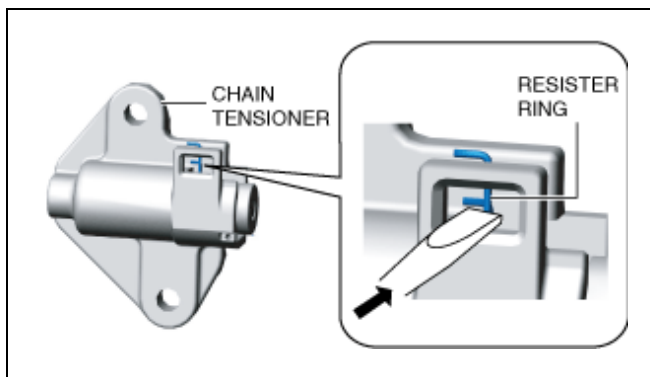

amxuuw0005409

(3) Press the timing chain in the direction of the arrow and press in the chain tensioner plunger to the position where the groove and body hole are aligned.

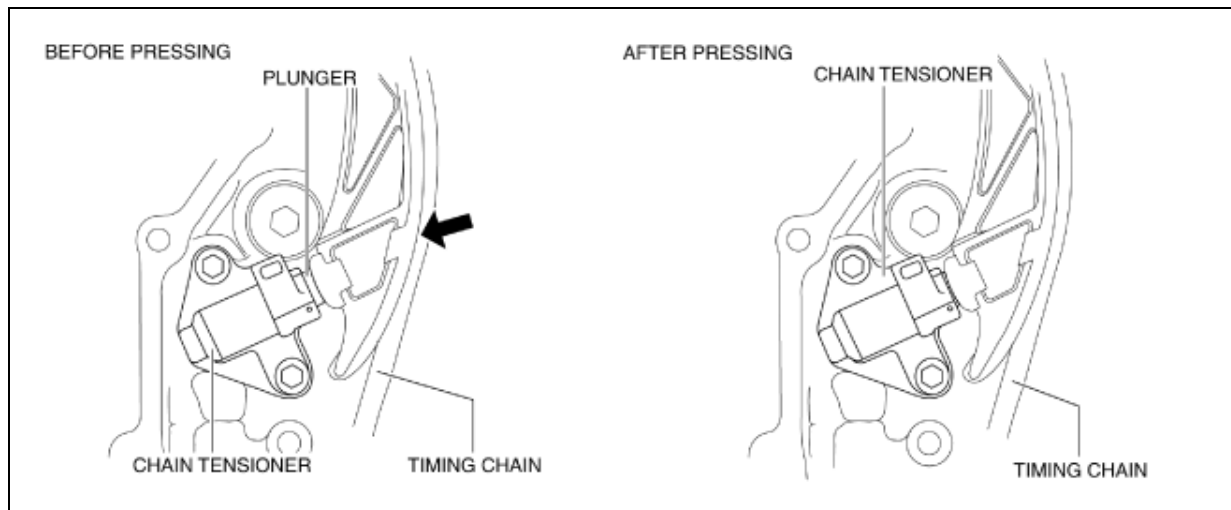

amxuuw0004405

(4) With the plunger pressed in, further insert the metal rod set in (1) above.

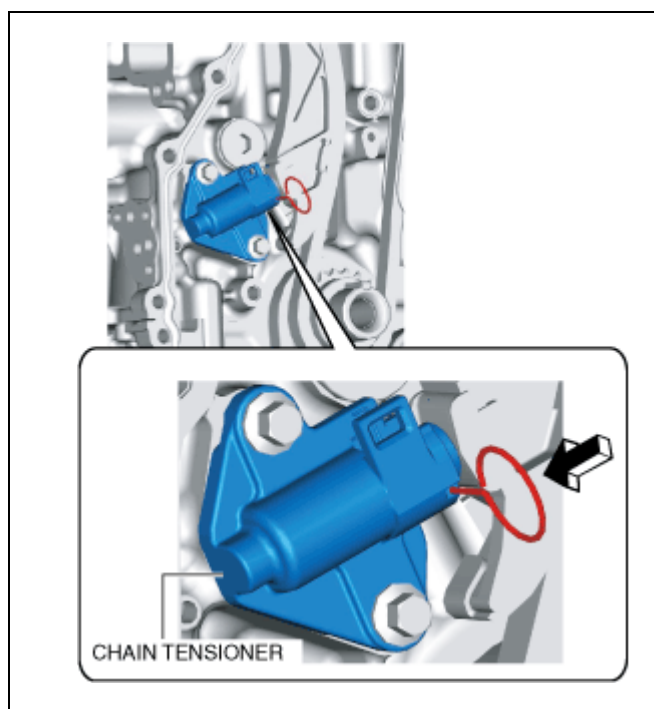

amxuuw00005410

Note

- The rod secures the plunger and releases the tension.

(5) Loosen the power of the hand pressing the plunger and verify that the pressed-in rod does not move.

3. Remove the chain tensioner, tensioner arm, and the chain guide (No.1).

4. Remove the timing chain.

Oil Pump Driven Sprocket Removal Note

1. Temporarily assemble the crankshaft pulley lock bolt, and lock the oil pump against rotation as shown in the figure.

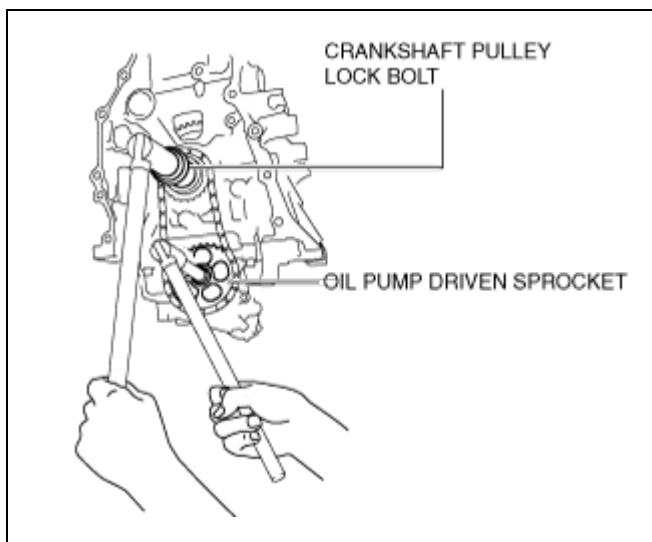

amxuuw00004407

2. Remove the oil pump driven sprocket.

3. Remove the temporarily assembled crankshaft pulley lock bolt.

Oil Pump Driven Sprocket Installation Note

1. Temporarily assemble the crankshaft pulley lock bolt, and lock the oil pump against rotation as shown in the figure.

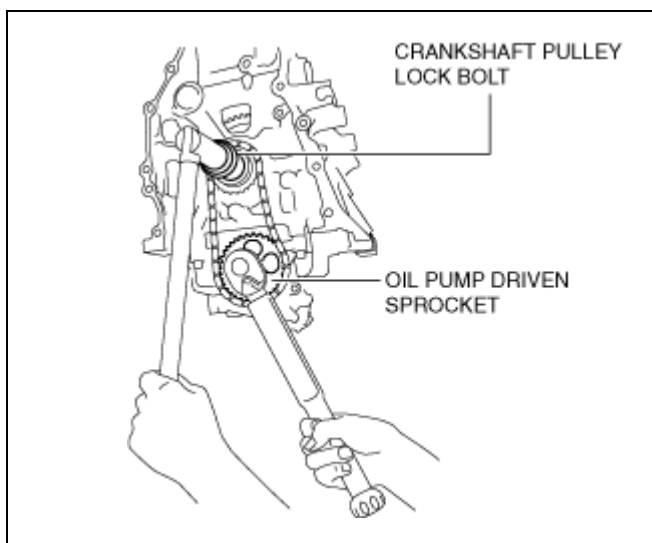

amxuuw00004408

2. Install the oil pump driven sprocket.

Tightening torque

26–36 N·m {2.7–3.6 kgf·m, 20–26 ft·lbf}

3. Remove the temporarily assembled crankshaft pulley lock bolt.

1. Verify that the timing marks and the key are aligned to the position shown in the figure.

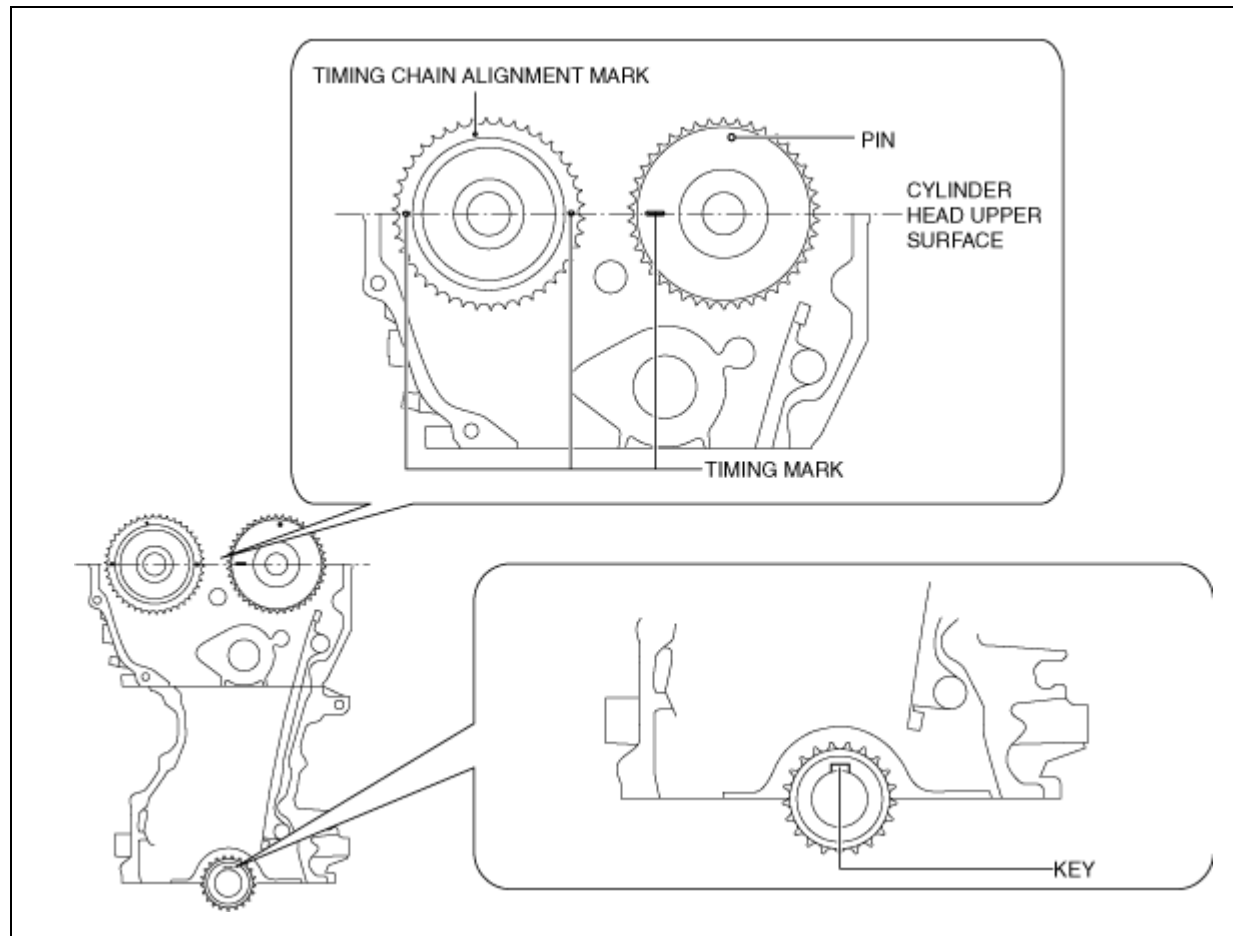

amxuuw0004409

• If the timing marks and key position have deviated, align them to the positions shown in the figure.

2. Install the timing chain while aligning the marks on the timing chain as shown in the figure.

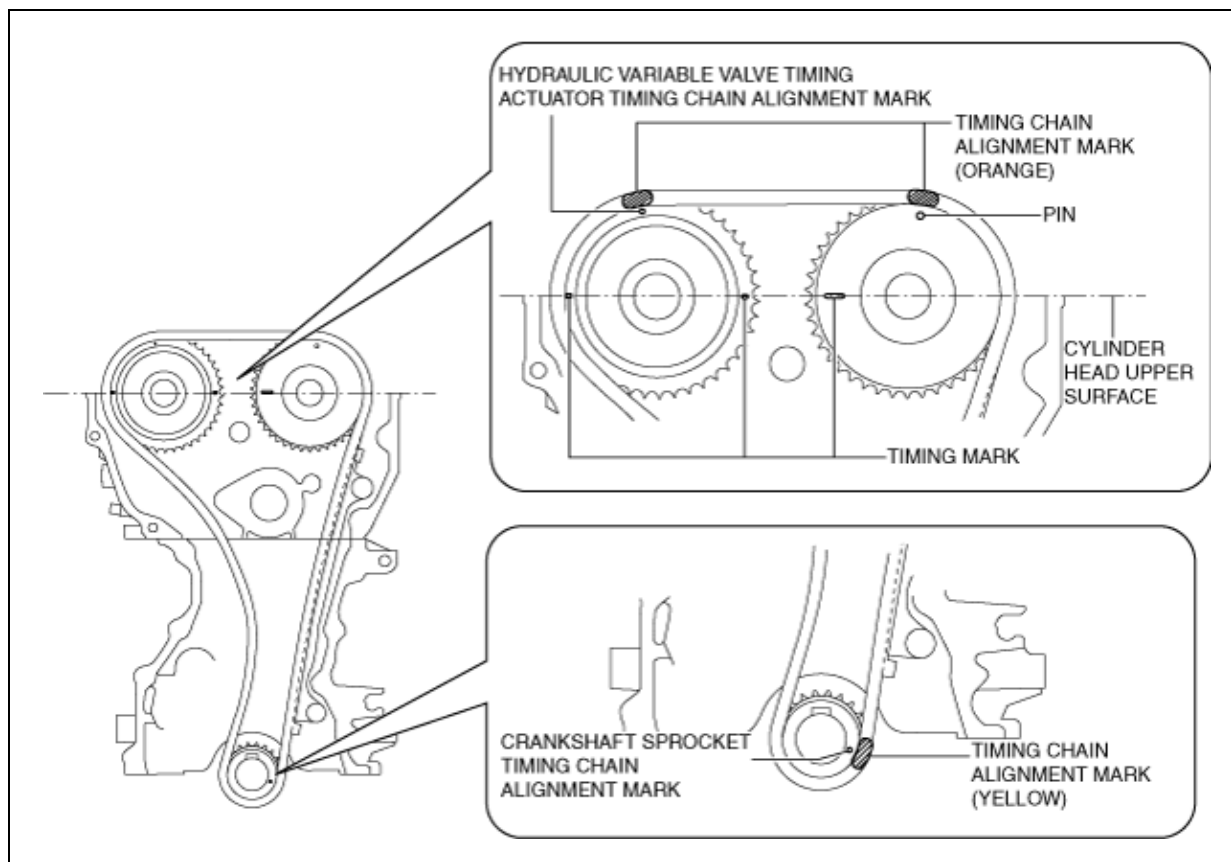

amxuuw0004410

3. Install the chain guide (No.1).

Tightening torque

8–11 N·m {82–112 kgf·cm, 71–97 in·lbf}

4. Install the tensioner arm.

5. Install the chain tensioner.

Tightening torque

8–11 N·m {82–112 kgf·cm, 71–97 in·lbf}

6. After installing the timing chain tensioner, remove the installed rod, and then apply tension to the timing chain.

- If a new chain tensioner is used, remove the installed lock pin.

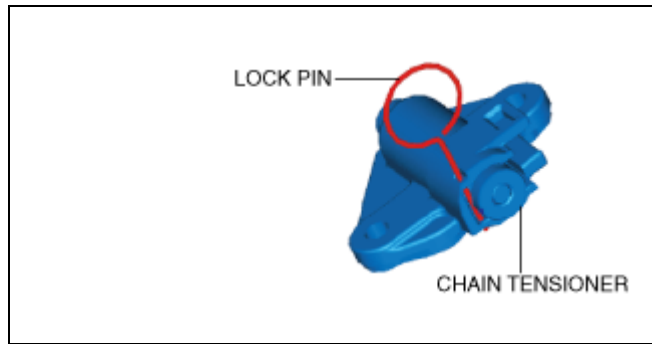

amxuuw00006023

7. Verify that there is no looseness in the timing chain, and re-verify that each sprocket is in the specified location.

8. Rotate the crankshaft clockwise two turns and inspect the valve timing.

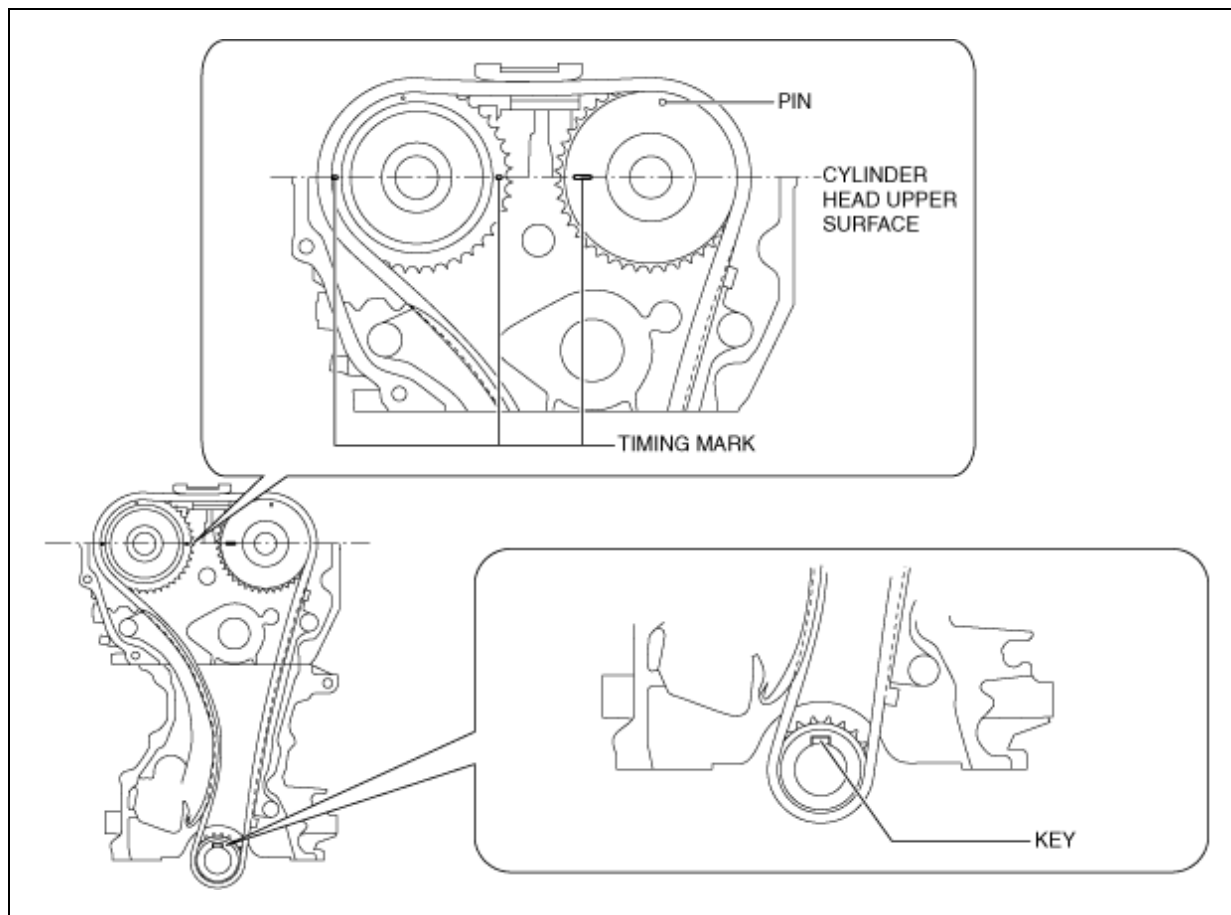

amxuuw00004403

Engine Front Cover Installation Note

Note

- For a new engine front cover, the positioning pins in the two locations shown in the figure project to the outside of the engine.

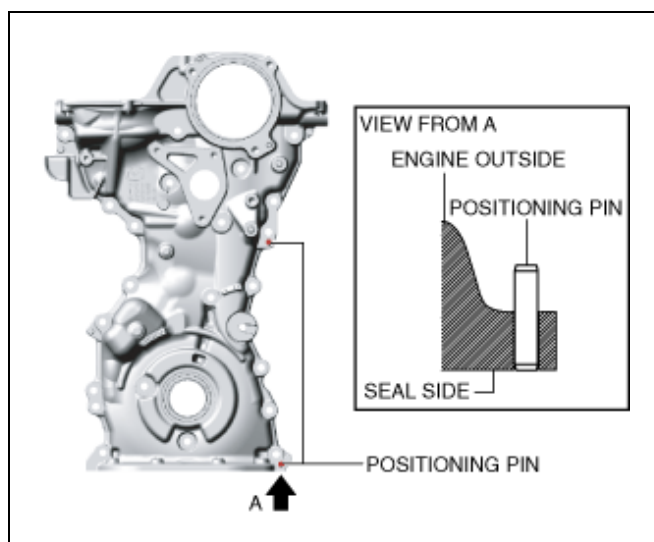

amxuuw00004412

1. If the engine front cover is newly replaced, tap the positioning pins in the two locations to the seal surface side.

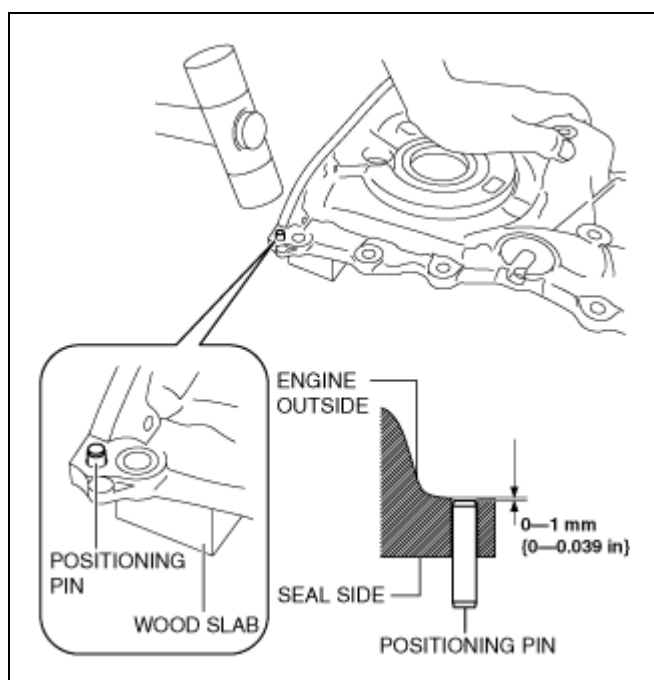

am2zzw00011132

Caution

- If a bolt with silicone sealant adhering to it is used, it could result in cracks in the cylinder head and cylinder block.

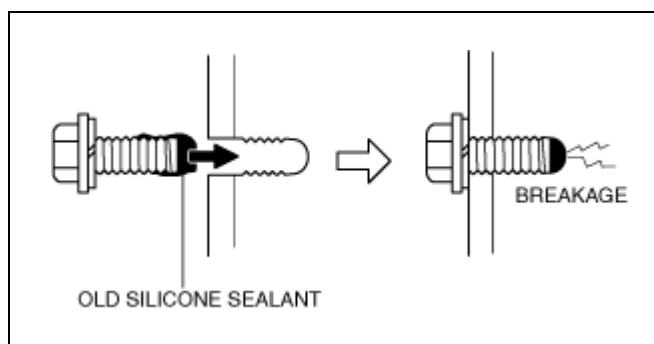

amxuuw00004413

2. When reusing an engine front cover installation bolts, remove silicone sealant adhering to the bolts.

Caution

- If oil, dirt and silicone sealant remains on the silicone sealant application area, the silicone sealant will not seal which will cause oil leakage.

3. Completely clean and remove oil, dirt, silicone sealant or other foreign matter that may be adhering to the engine front cover, cylinder head, and cylinder block.

Caution

- Apply the silicon sealant in a single, unbroken line.
- To prevent silicone sealant from hardening, adhere the engine front cover and the cylinder block firmly within 10 min. after applying silicone sealant. After adhering them, tighten the installation bolts immediately.

4. Apply silicone sealant (TB1217D or equivalent) to the engine front cover as shown in the figure.

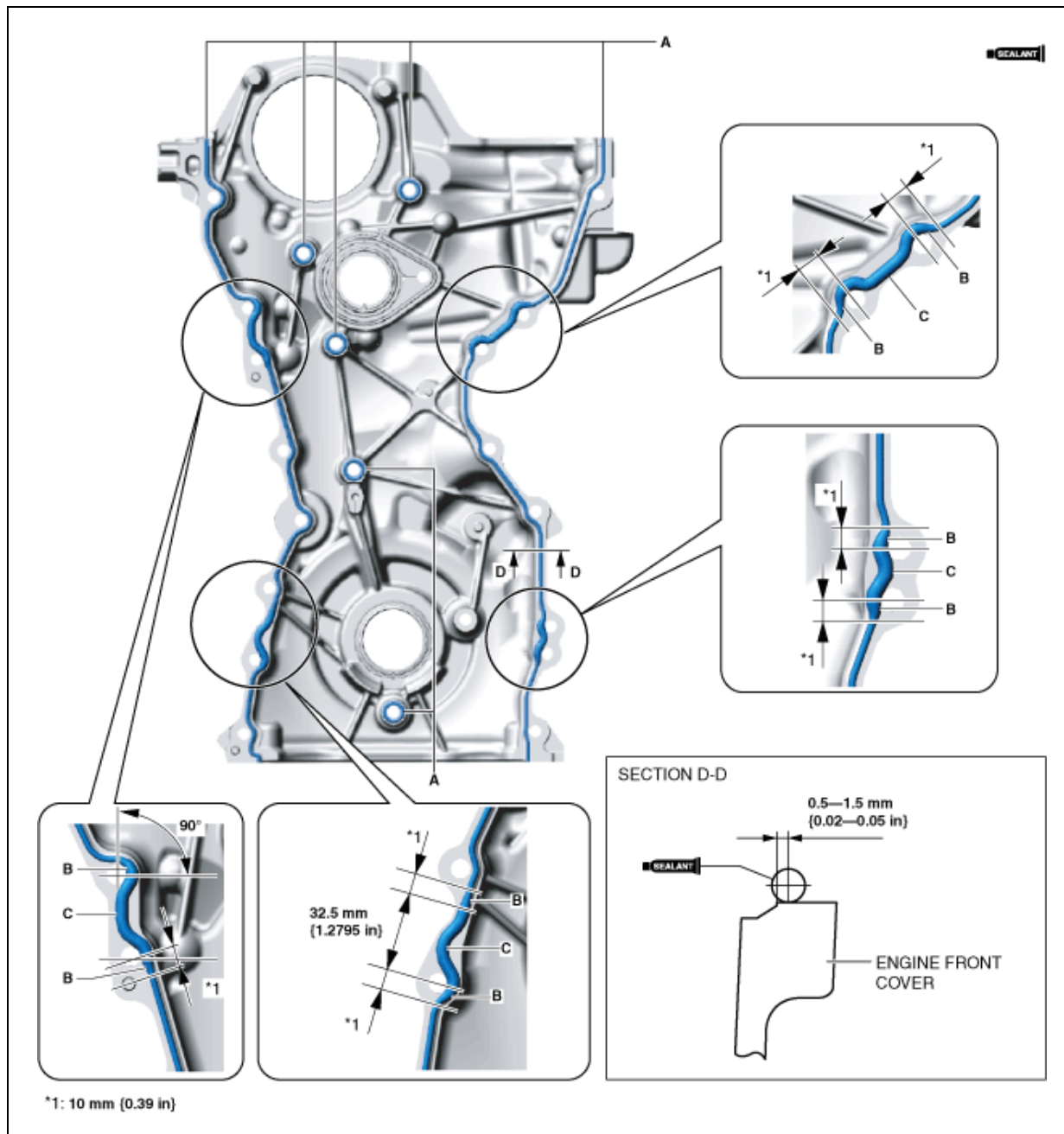

amxuuw0005411

Bead thickness

- A: 2–6 mm {0.1–0.2 in}
- B: 4–6 mm {0.16–0.23 in}
- C: 4–8 mm {0.2–0.3 in}

Caution

- Apply the silicone sealant so that it goes into the cylinder head gasket.

5. Apply silicone sealant (TB1217D or equivalent) to the areas shown in the figure.

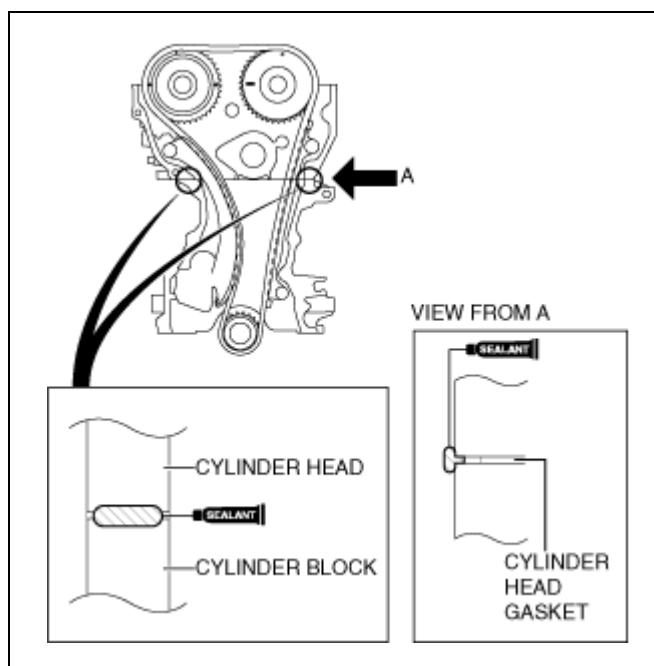

amxuuw00004415

Caution

- Do not apply engine coolant to the O-ring (1). Otherwise, the O-ring could swell causing a seal malfunction.

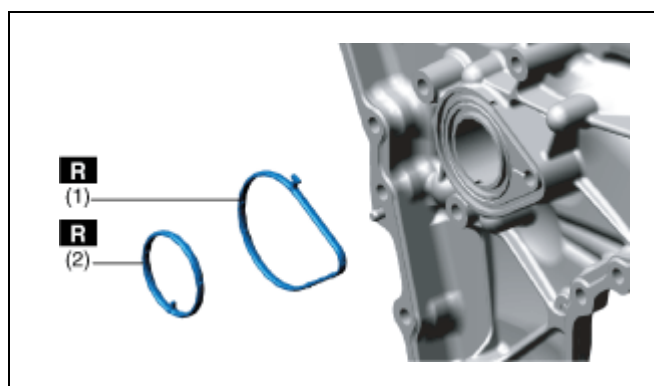

amxuuw00004416

- Do not apply oil (such as engine oil, ATF) to the O-ring (2). Otherwise, the O-ring could swell causing a seal malfunction.

6. Install a new O-ring to the O-ring installation groove of the engine front cover.

7. Install the engine front cover to the engine.

Note

- Temporarily install an appropriate bolt to the drive belt auto tensioner installation bolt hole to prevent:
 - A silicone sealant adhesion malfunction in the drive belt auto tensioner installation bolt hole.
 - A bolt mis-installation due to silicone sealant hardening.

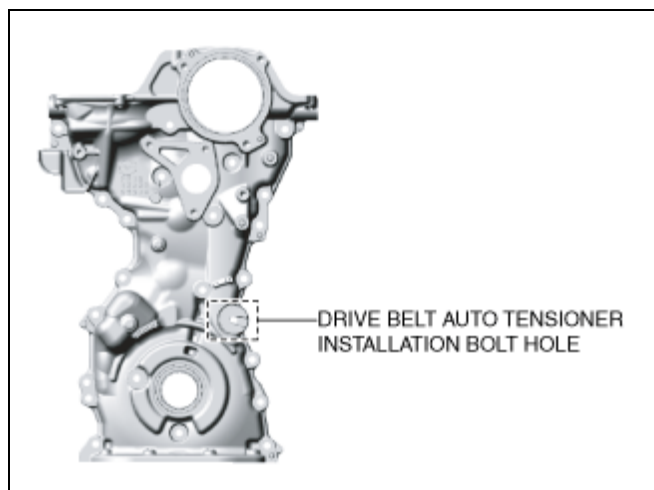

amxuuw00004417

8. Prepare an appropriate M8 × 1.25 bolt (length 40 mm {1.6 in}).

Caution

- For the number 3 bolt of the tightening order, install the bolt with new washer.

9. Tighten the engine front cover installation bolts in the order shown in the figure.

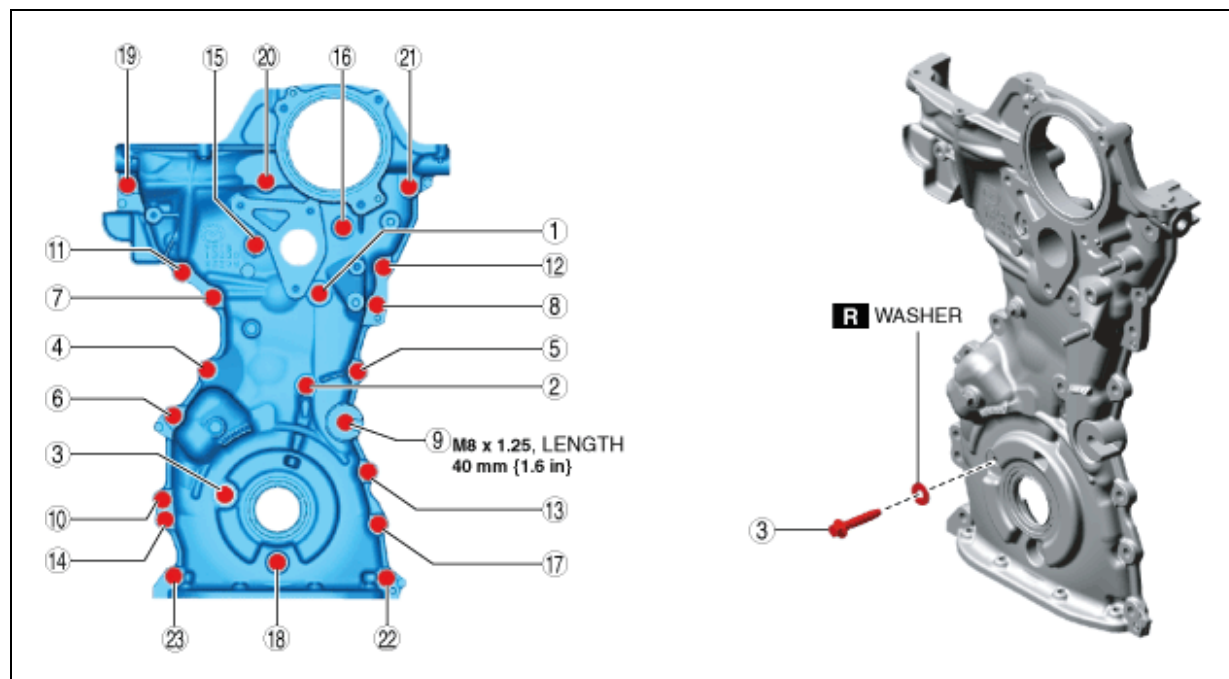

amxuuw00005412

Tightening torque

20–26 N·m {2.1–2.6 kgf·m, 15–19 ft·lbf}

10. Remove the bolt installed to the drive belt auto tensioner installation bolt hole when installing the drive belt auto

11. Return the engine wiring harness to its original position using the following procedure.

(1) Connect or install the following parts.

Step 1

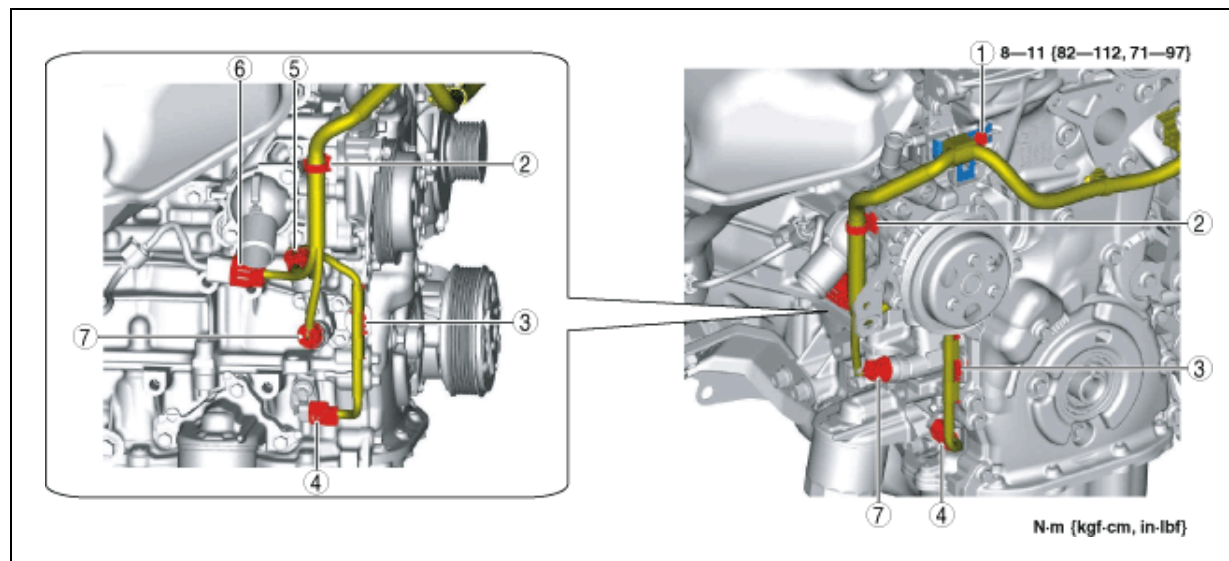

amxuuw0005635

1	Bolt
2	Wiring harness clip
3	Wiring harness clip
4	Crankshaft position (CKP) sensor connector
5	Engine oil solenoid valve connector
6	A/F sensor connector
7	Oil pressure switch connector

Step 2

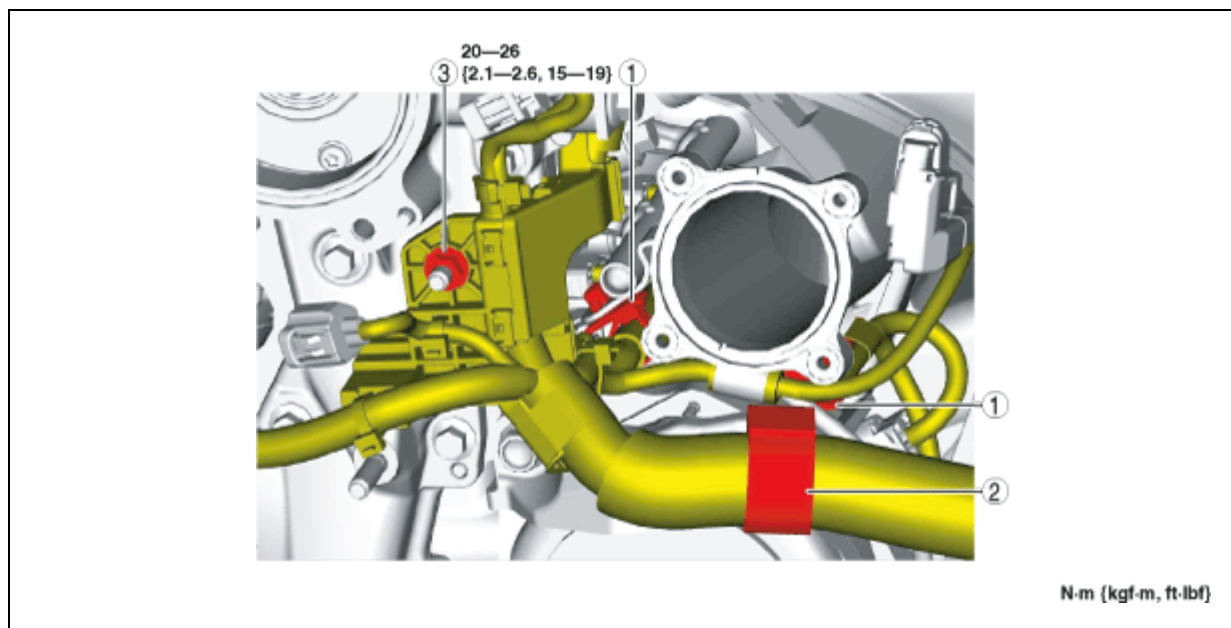

amxuuw0005636

1	Wiring harness clip
2	Wiring harness clip
3	Wiring harness protector installation nut

(2) Install the throttle body. (See INTAKE-AIR SYSTEM REMOVAL/INSTALLATION [SKYACTIV-G 2.0] .)

(3) Connect or install the following parts.

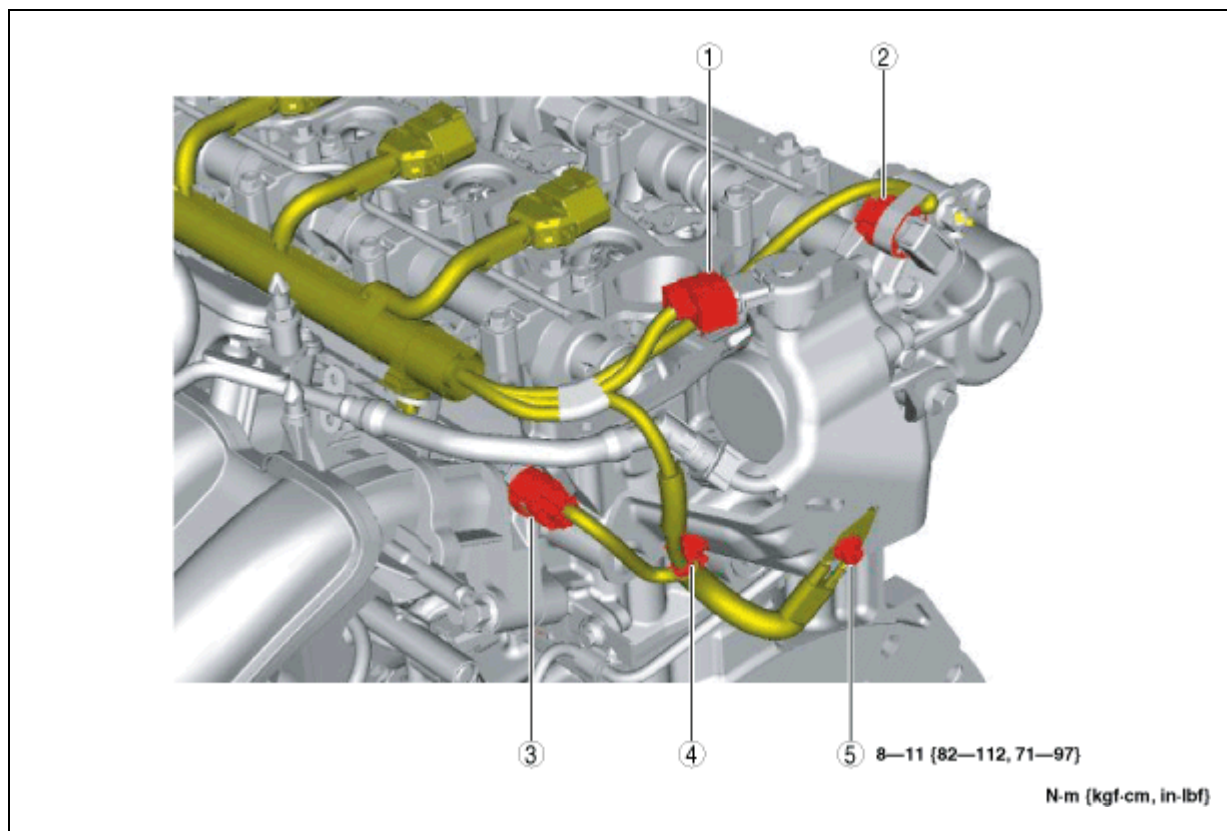

amxuuw00005637

1	High pressure fuel pump connector
2	Exhaust camshaft position sensor connector
3	Intake camshaft position sensor connector
4	Wiring harness clip
5	Bolt

(4)Connect the purge solenoid valve connector. (See PURGE SOLENOID VALVE REMOVAL/INSTALLATION [SKYACTIV-G 2.0] .)

Water Outlet Component Installation Note

Caution

- Do not apply oil (such as engine oil, ATF) to the gasket. Otherwise, the gasket could swell causing a seal malfunction.

Oil Shower Pipe Installation Note

1. Install the oil shower pipe in the order shown in the figure.

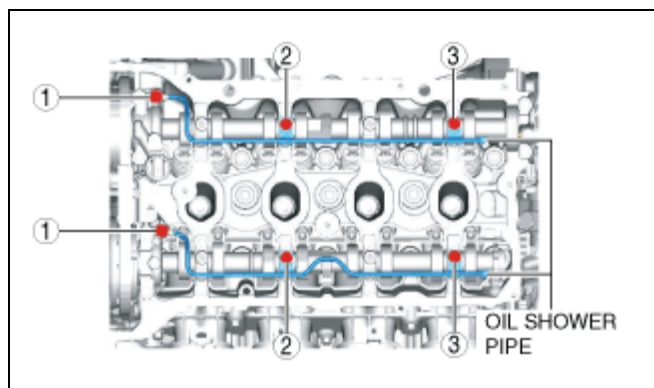

amxuuw00004423

Tightening torque

Installation position	Tightening torque
1	9–12 N·m {92–122 kgf·cm, 80–106 in·lbf}
2, 3	8.0–9.0 N·m {82–91 kgf·cm, 71–79 in·lbf}

Cylinder Head Cover Installation Note

Caution

- To assure the sealing performance of the cylinder head cover, be careful of the following:
 - Verify that the cylinder head cover gasket is inserted into the cylinder head cover groove and install the cylinder head cover.
 - Completely clean and remove oil, dirt, silicone sealant or other foreign matter from the seal surface.
- To prevent silicone sealant from hardening, adhere the cylinder head cover and the cylinder head firmly within 10 min. after applying silicone sealant. After adhering them, tighten the installation bolts immediately.

1. Insert a new cylinder head cover gasket into the cylinder head cover groove.

2. Apply silicone sealant (TB1217D or equivalent) to the areas shown in the figure.

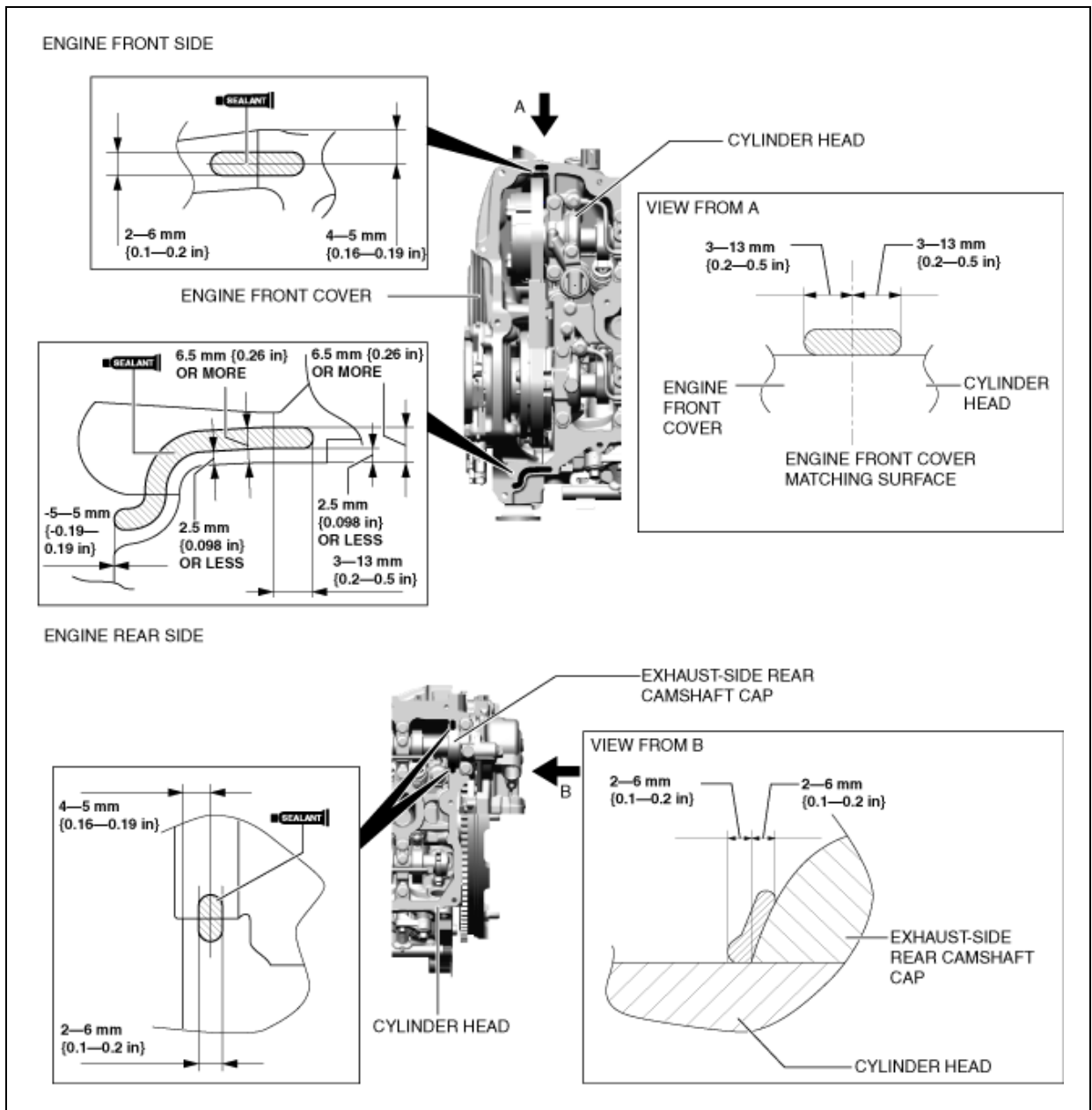

amxuuw00005638

3. Tighten the cylinder head cover bolts in the order shown in the following 3 steps.

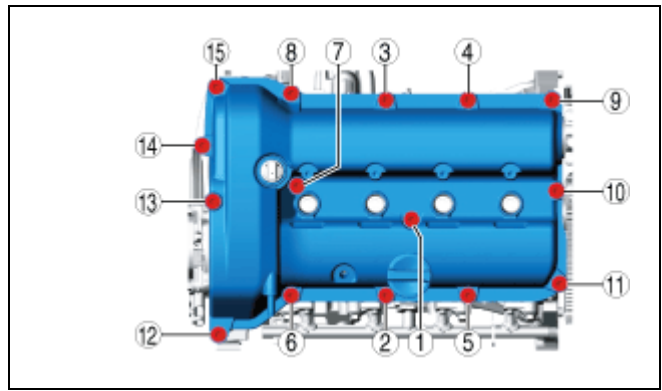

amxuuw00004425

- Step 1: 6–10 N·m {62–101 kgf·cm, 54–88 in·lbf}
- Step 2: 6–10 N·m {62–101 kgf·cm, 54–88 in·lbf}
- Step 3: 6–10 N·m {62–101 kgf·cm, 54–88 in·lbf}

4. Measure the tightening torque again and verify that it is 6 N·m {62 kgf·cm, 54 in·lbf} or more.

5. Install in the reverse order of removal.
