

COMPONENT LOCATOR

TRANSFER CASE CONTROL COMPONENT VIEWS

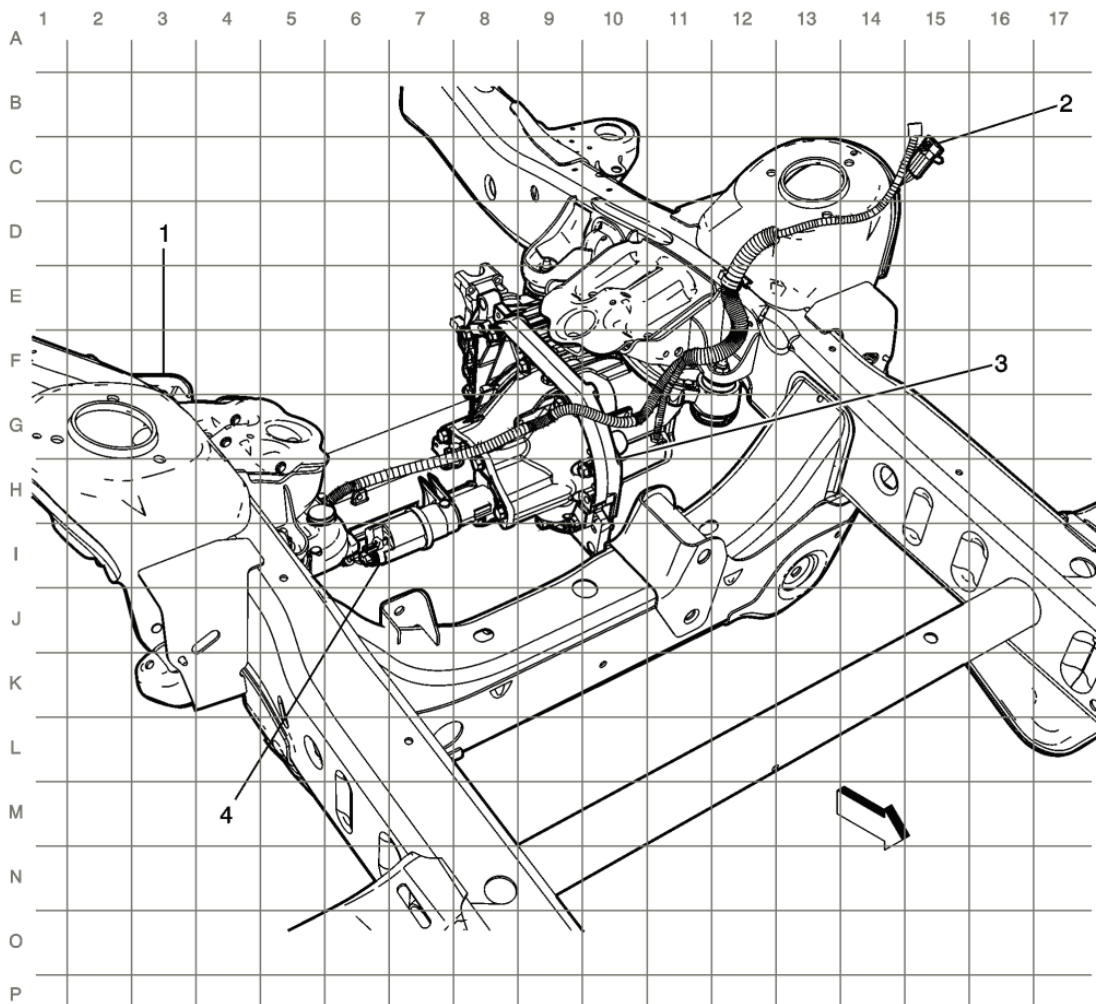

Fig. 5: Front Axle (NP8)

Courtesy of GENERAL MOTORS CORP.

Callout	Component Name
1	Frame
2	C110
3	Front Axle Housing
4	Front Axle Actuator

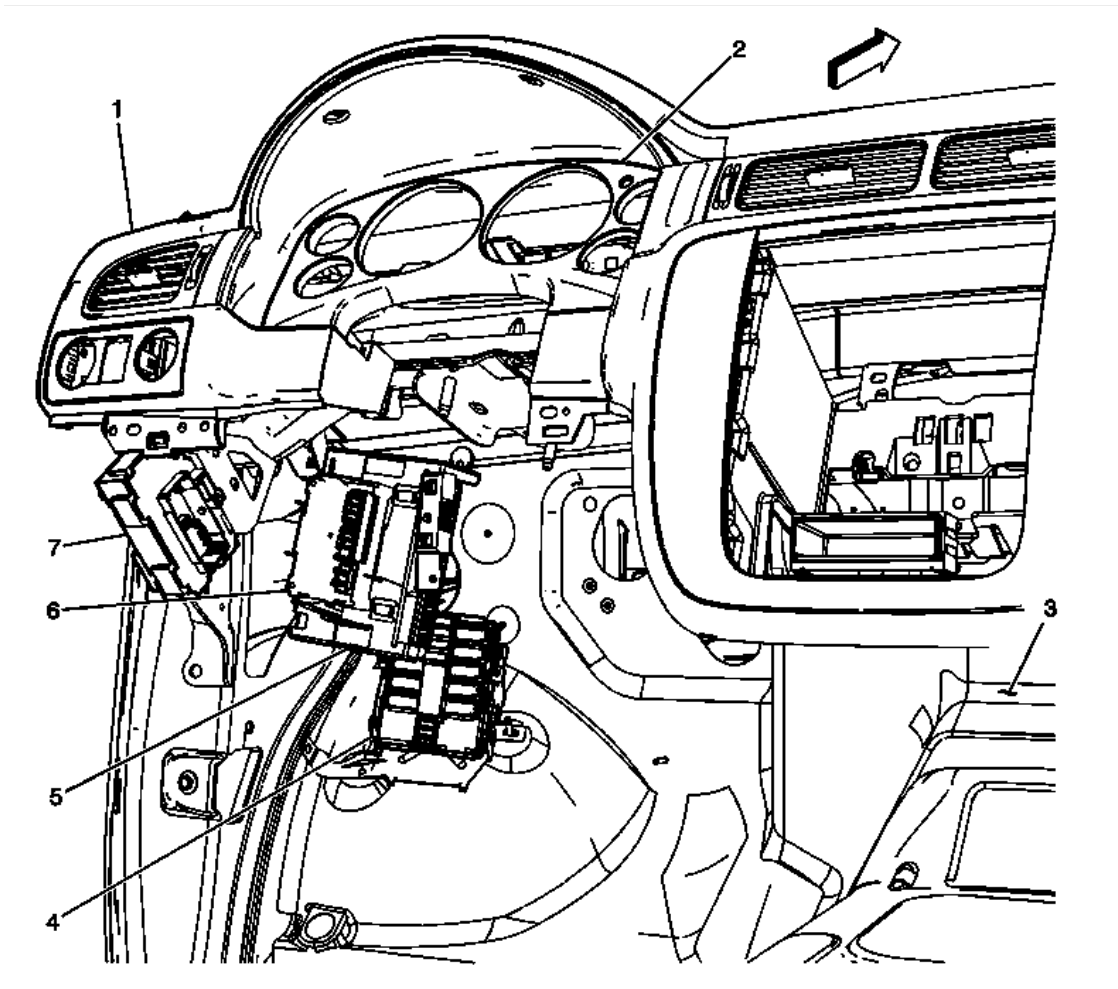

Fig. 6: Below the I/P
 Courtesy of GENERAL MOTORS CORP.

Callout	Component Name
1	I/P Trim
2	I/P Cluster Trim
3	Floor Panel
4	Junction Block - Left I/P
5	Body Control Module (BCM)
6	Transfer Case Shift Control Module
7	Fuse Block - I/P

2007 Chevrolet Tahoe

2007 TRANSMISSION Transfer Case - NVG 246-NP8 - Avalanche, Escalade, Suburban, Tahoe & Yukon

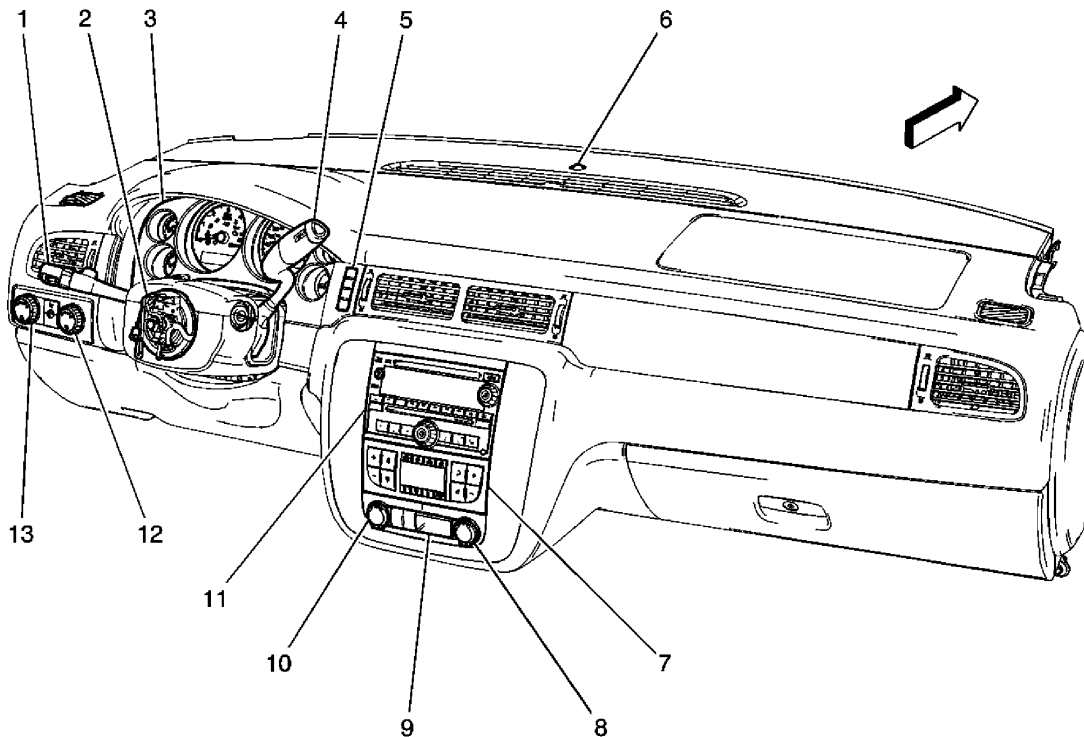

Fig. 7: Front of the I/P (Except Z75)
 Courtesy of GENERAL MOTORS CORP.

Callout	Component Name
1	Turn Signal Multifunction Switch
2	Inflatable Restraint Steering Wheel Module Coil
3	Instrument Panel Cluster (IPC)
4	Tow/Haul Switch
5	Driver Information Center (DIC) Switch
6	Ambient Light/Sunload Sensor Assembly (CJ2) or Ambient Light Sensor (CJ3)
7	HVAC Control Module
8	Auxiliary Power Outlet - Front 2
9	I/P Multifunction Switch Assembly
10	Auxiliary Power Outlet - Front 1
11	Radio
12	Transfer Case Shift Control Switch
13	Headlamp and Panel Dimmer Switch

TRANSFER CASE CONTROL CONNECTOR END VIEWS

Front Axle Actuator

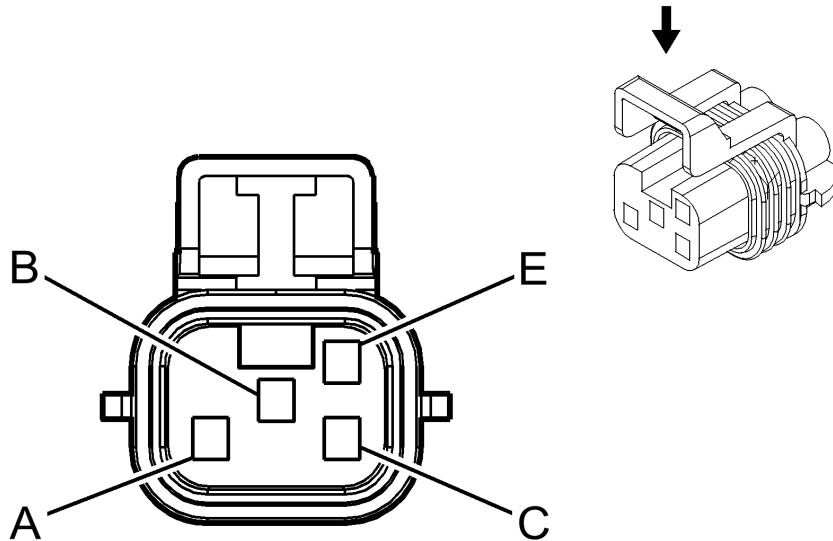

Fig. 8: Front Axle Actuator Connector End View
 Courtesy of GENERAL MOTORS CORP.

Front Axle Actuator Connector Parts Information

Connector Part Information

- OEM: 15324541
- Service: 12117277
- Description: 4-Way F Metri-Pack 150 Series, Sealed (BU)

Terminal Part Information

- Terminal/Tray: 12048074/2
- Core/Insulation Crimp: E/1
- Release Tool/Test Probe: 12094429/J-35616-2A (GY)

Front Axle Actuator Connector Terminal Identification

Pin	Wire Color	Circuit No.	Function
A	TN/WH	1695	Axle Switch Signal
B	GY/BK	1570	Front Axle Actuator Control
C	BN	241	Ignition 3 Voltage
D	-	-	Not Available
E	BK	550	Ground

Propshaft Speed Sensor - Front (NP8)

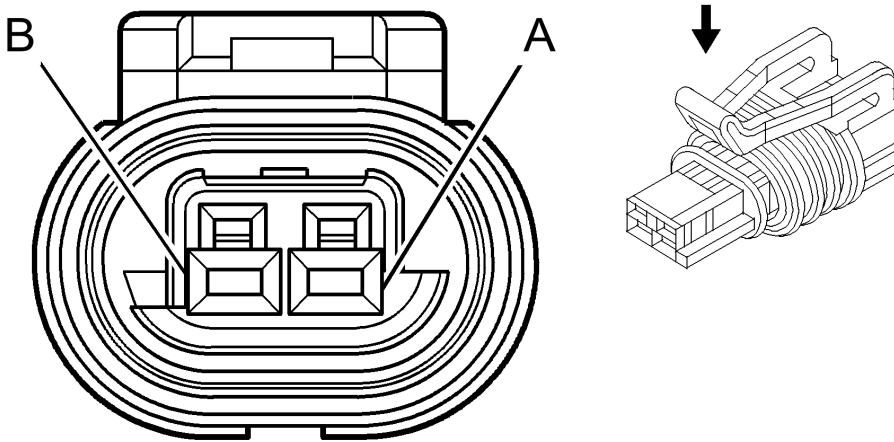

Fig. 9: Propshaft Speed Sensor - Front (NP8) Connector End View
 Courtesy of GENERAL MOTORS CORP.

Propshaft Speed Sensor - Front (NP8) Connector Parts Information

Connector Part Information	
• OEM: 15449028	
• Service: 88987993	
• Description: 2-Way F 150 GT Series Sealed (BK)	
Terminal Part Information	
• Terminal/Tray: 15326267/19	
• Core/Insulation Crimp: E/4	
• Release Tool/Test Probe: 15315247/J-35616-2A (GY)	

Propshaft Speed Sensor - Front (NP8) Connector Terminal Identification

Pin	Wire Color	Circuit No.	Function
A	YE	400	Signal High - Front/VSS High Signal/OSS High Signal
B	PU	401	Signal Low - Front/VSS Low Signal/OSS Low Signal

Propshaft Speed Sensor - Rear (NP8)

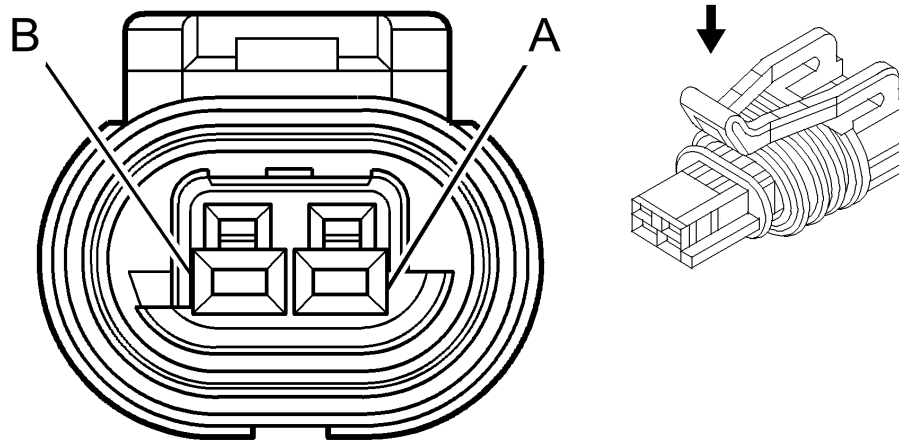

Fig. 10: Propshaft Speed Sensor - Rear (NP8) Connector End View
 Courtesy of GENERAL MOTORS CORP.

Propshaft Speed Sensor - Rear (NP8) Connector Parts Information

Connector Part Information

- OEM: 15449028
- Service: 88987993
- Description: 2-Way F 150 GT Series Sealed (BK)

Terminal Part Information

- Terminal/Tray: 15326267/19
- Core/Insulation Crimp: E/4
- Release Tool/Test Probe: 15315247/J-35616-2A (GY)

Propshaft Speed Sensor - Rear (NP8) Connector Terminal Identification

Pin	Wire Color	Circuit No.	Function
A	L-BU	2221	Signal High - Rear
B	D-GN	2222	Signal Low - Rear

Transfer Case Encoder Motor (NP8)

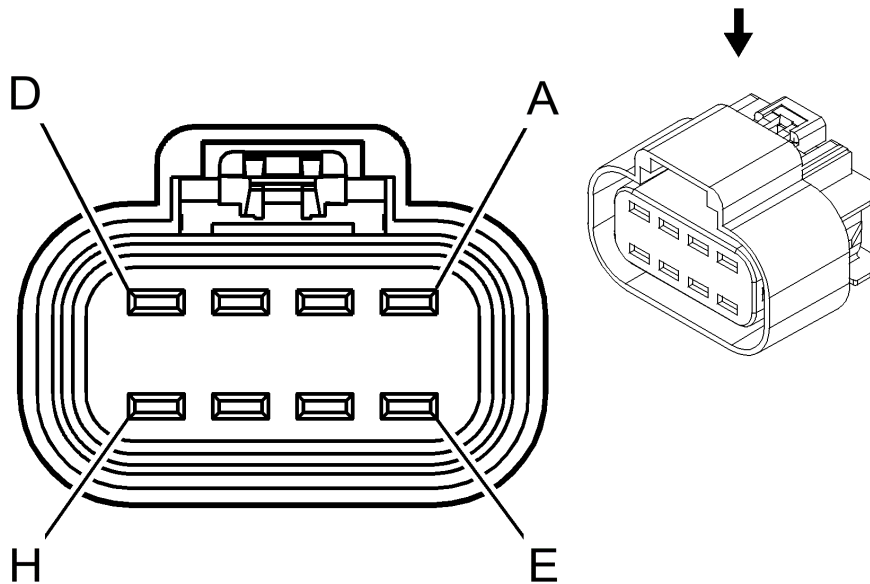

Fig. 11: Transfer Case Encoder Motor (NP8) Connector End View
 Courtesy of GENERAL MOTORS CORP.

Transfer Case Encoder Motor (NP8) Connector Parts Information

Connector Part Information

- OEM: 15326654
- Service: 88986254
- Description: 8-Way F GT 280 Series Sealed (BK)

Terminal Part Information

- Pins: A-C
- Terminal/Tray: 15304719/19
- Core/Insulation Crimp: E/5
- Release Tool/Test Probe: 15315247/J-35616-4A (PU)

- Pins: D-G
- Terminal/Tray: 15304720/19
- Core/Insulation Crimp: 4/5
- Release Tool/Test Probe: 15315247/J-35616-4A (PU)

Transfer Case Encoder Motor (NP8) Connector Terminal Identification

Pin	Wire Color	Circuit No.	Function
A	L-GN/BK	6028	Transfer Case Encoder 5-Volt Reference

2007 Chevrolet Tahoe

2007 TRANSMISSION Transfer Case - NVG 246-NP8 - Avalanche, Escalade, Suburban, Tahoe & Yukon

B	BN/WH	1555	Channel P Encoder - Signal
C	TN/WH	1554	Encoder Low Reference
D	TN	1552	Motor Control A
E	OG	1553	Motor Control B
F	RD/BK	1342	Battery Positive Voltage
G	TN	1569	Lock Solenoid Control
H	-	-	Not Used

Transfer Case Shift Control Module C1

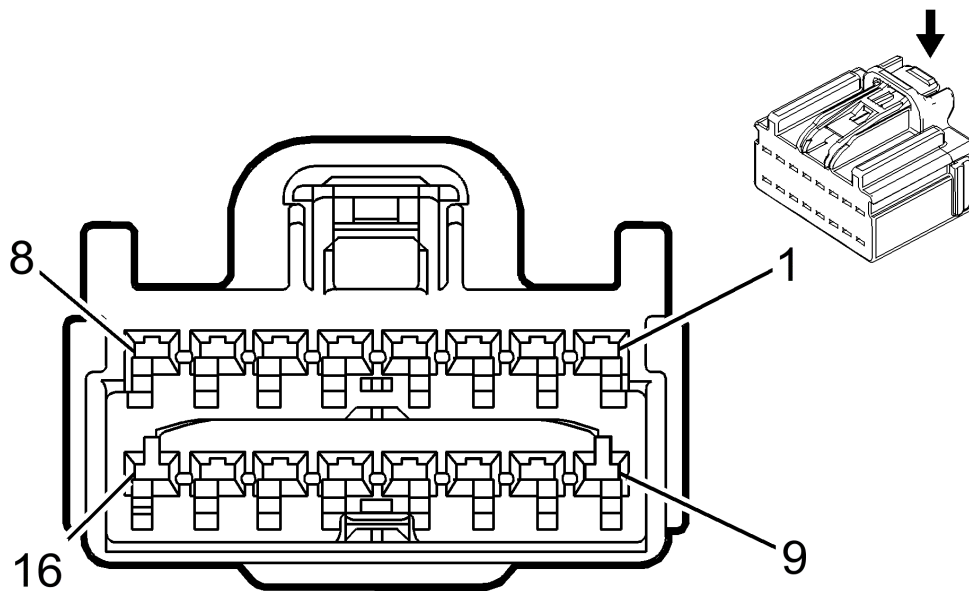

Fig. 12: Transfer Case Shift Control Module C1 Connector End View
Courtesy of GENERAL MOTORS CORP.

Transfer Case Shift Control Module C1 Connector Parts Information

Connector Part Information

- OEM: 13506916
- Service: 88988265
- Description: 16-Way F Kaizen 1.5 Series (BU)

Terminal Part Information

- Pins: 2-6, 9-15
- Terminal/Tray: 7116-4100-08/9
- Core/Insulation Crimp: E/C

2007 Chevrolet Tahoe

2007 TRANSMISSION Transfer Case - NVG 246-NP8 - Avalanche, Escalade, Suburban, Tahoe & Yukon

- Release Tool/Test Probe: 12094430/J-35616-2A (GY)
- Pin: 7
- Terminal/Tray: 7116-4101-08/9
- Core/Insulation Crimp: E/A
- Release Tool/Test Probe: 12094430/J-35616-2A (GY)

Transfer Case Shift Control Module C1 Connector Terminal Identification

Pin	Wire Color	Circuit No.	Function
1	-	-	Not Used
2	GY	6029	5-Volt Reference
3	BN/WH	1555	Channel P Encoder - Signal
4	GY/BK	1694	4WD Low Signal
5	BN	1560	Neutral Indicator Control
6	L-GN/BK	1563	2 'HI' Indicator - Control
7	TN	1569	Lock Solenoid Control
8	-	-	Not Used
9	L-GN/BK	6028	Transfer Case Encoder 5-Volt Reference
10	TN/WH	1554	Encoder Low Reference
11	L-BU	1693	Switch Signal
12	TN/BK	1566	4 'HI' Indicator - Control
13	PU/WH	1565	4 'LO' Indicator - Control
14	PK	1561	AWD Indicator Control
15	GY/BK	1570	Front Axle Actuator Control
16	-	-	Not Used

Transfer Case Shift Control Module C2

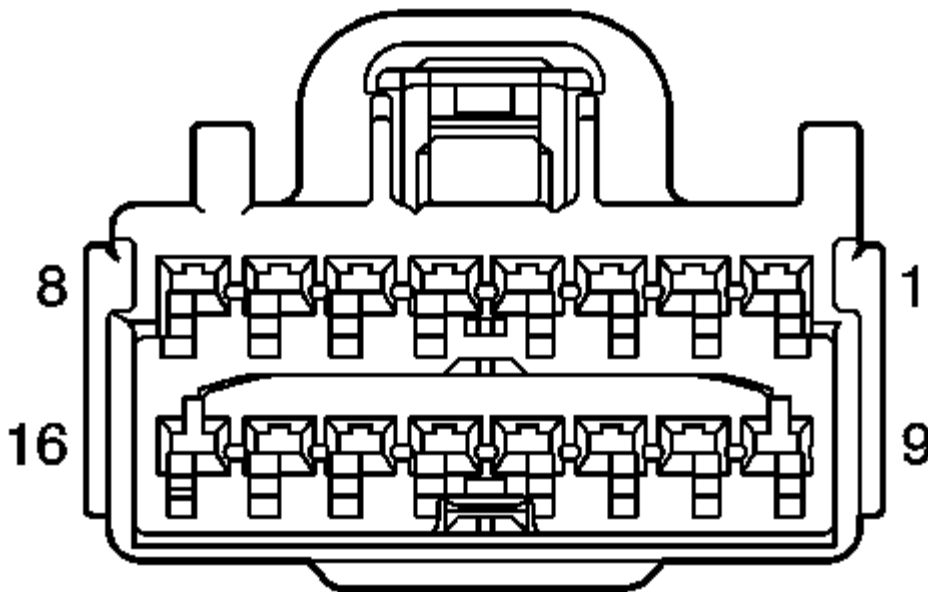

Fig. 13: Transfer Case Shift Control Module C2 Connector End View
 Courtesy of GENERAL MOTORS CORP.

Transfer Case Shift Control Module C2 Connector Parts Information

Connector Part Information

- OEM: 13506917
- Service: 19115709
- Description: 16-Way F Kaizen 1.5 Series (L-GY)

Terminal Part Information

- Terminal/Tray: 7116-4100-08/9
- Core/Insulation Crimp: E/C
- Release Tool/Test Probe: 12094430/J-35616-2A (GY)

Transfer Case Shift Control Module C2 Connector Terminal Identification

Pin	Wire Color	Circuit No.	Function
1-2	-	-	Not Used
3	TN/WH	1695	Axle Switch Signal
4	TN	2501	High Speed GMLAN Serial Data Bus-

2007 Chevrolet Tahoe

2007 TRANSMISSION Transfer Case - NVG 246-NP8 - Avalanche, Escalade, Suburban, Tahoe & Yukon

5	TN/BK	2500	High Speed GMLAN Serial Data Bus+
6	-	-	Not Used
7	D-GN	2222	Signal Low - Rear
8	L-BU	2221	Signal High - Rear
9	PK	239	Ignition 1 Voltage
10	D-BU	5985	Accessory Wakeup Serial Data
11	-	-	Not Used
12	TN	2501	High Speed GMLAN Serial Data Bus-
13	TN/BK	2500	High Speed GMLAN Serial Data Bus+
14	-	-	Not Used
15	YE	400	Signal High - Front/VSS High Signal/OSS High Signal
16	PU	401	Signal Low - Front/VSS Low Signal/OSS Low Signal

Transfer Case Shift Control Module C3

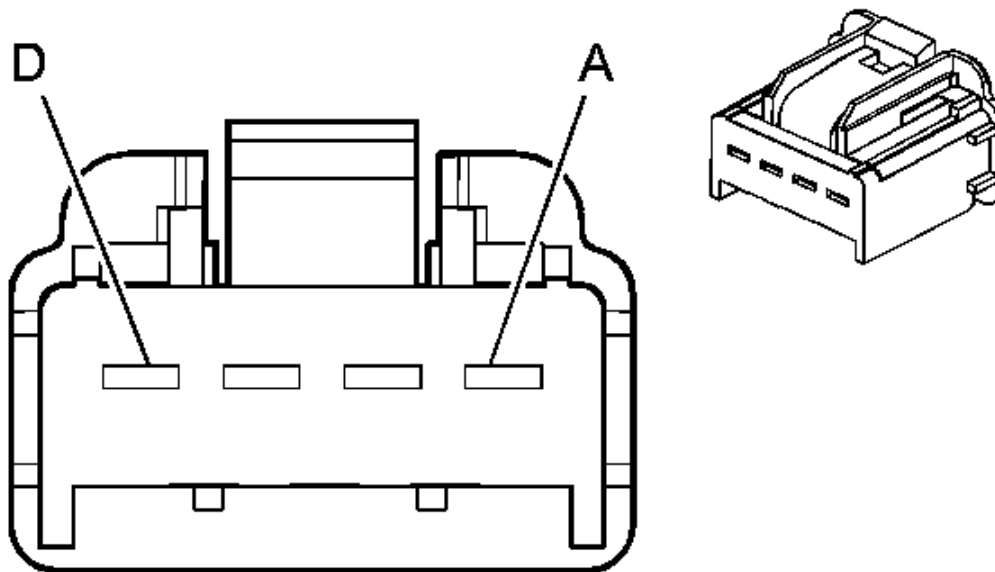

Fig. 14: Transfer Case Shift Control Module C3 Connector End View
 Courtesy of GENERAL MOTORS CORP.

Transfer Case Shift Control Module C3 Connector Parts Information

Connector Part Information

- OEM: 15466671
- Service: 19149301
- Description: 4-Way F GT 280 Series (L-GY)

Terminal Part Information

- Terminal/Tray: 15304713/19
- Core/Insulation Crimp: F/D
- Release Tool/Test Probe: 15315247/J-35616-4A (PU)

Transfer Case Shift Control Module C3 Connector Terminal Identification

Pin	Wire Color	Circuit No.	Function
A	OG	1553	Motor Control B
B	TN	1552	Motor Control A
C	RD/BK	1342	Battery Positive Voltage
D	BK	550	Ground

Transfer Case Shift Control Switch

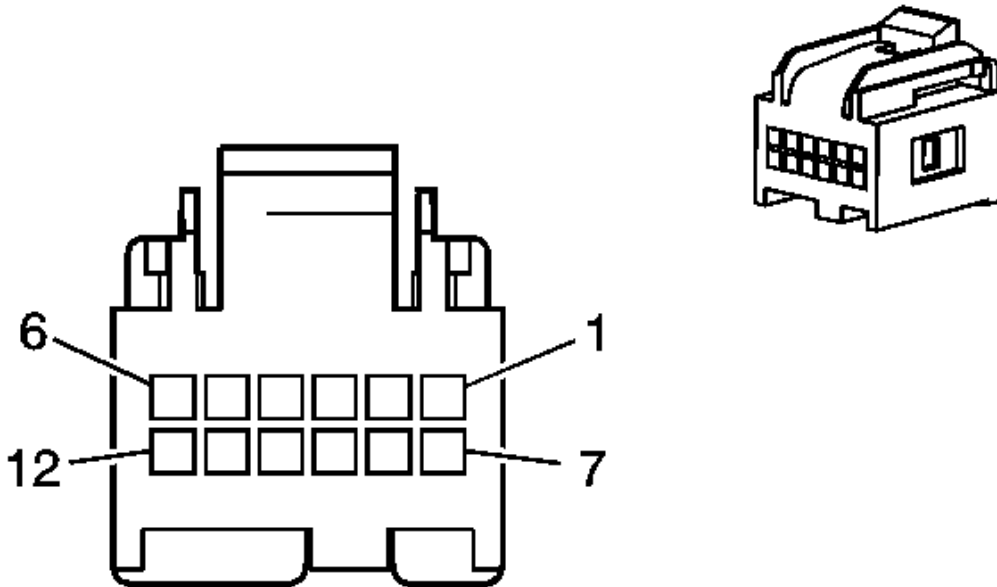

Fig. 15: Transfer Case Shift Control Switch Connector End View
 Courtesy of GENERAL MOTORS CORP.

2007 Chevrolet Tahoe

2007 TRANSMISSION Transfer Case - NVG 246-NP8 - Avalanche, Escalade, Suburban, Tahoe & Yukon

Transfer Case Shift Control Switch Connector Parts Information

Connector Part Information

- OEM: 13551678
- Service: 89047364
- Description: 12-Way F Receptacle 0.64 Series (BK)

Terminal Part Information

- Terminal/Tray: 7116-4618-02/14
- Core/Insulation Crimp: P/P
- Release Tool/Test Probe: J-38125-215/J-35616-64B (L-BU)

Transfer Case Shift Control Switch Connector Terminal Identification

Pin	Wire Color	Circuit No.	Function
1	-	-	Not Used
2	WH	2283	Rear Wiper/Washer Switch Supply Voltage
3	BN	1560	Neutral Indicator Control
4	PU/WH	6816	Indicator Dimming Control
5	BN/WH	230	Instrument Panel Lamp Dimming Control
6	BK	1050	Ground
7	PK	1561	AWD Indicator Control
8	L-GN/BK	1563	2 'HI' Indicator - Control
9	TN/BK	1566	4 'HI' Indicator - Control
10	PU/WH	1565	4 'LO' Indicator - Control
11	GY	6029	Four Wheel Drive Mode Switch 5-Volt Reference
12	L-BU	1693	Switch Signal

TRANSFER CASE DISASSEMBLED VIEW

2007 Chevrolet Tahoe

2007 TRANSMISSION Transfer Case - NVG 246-NP8 - Avalanche, Escalade, Suburban, Tahoe & Yukon

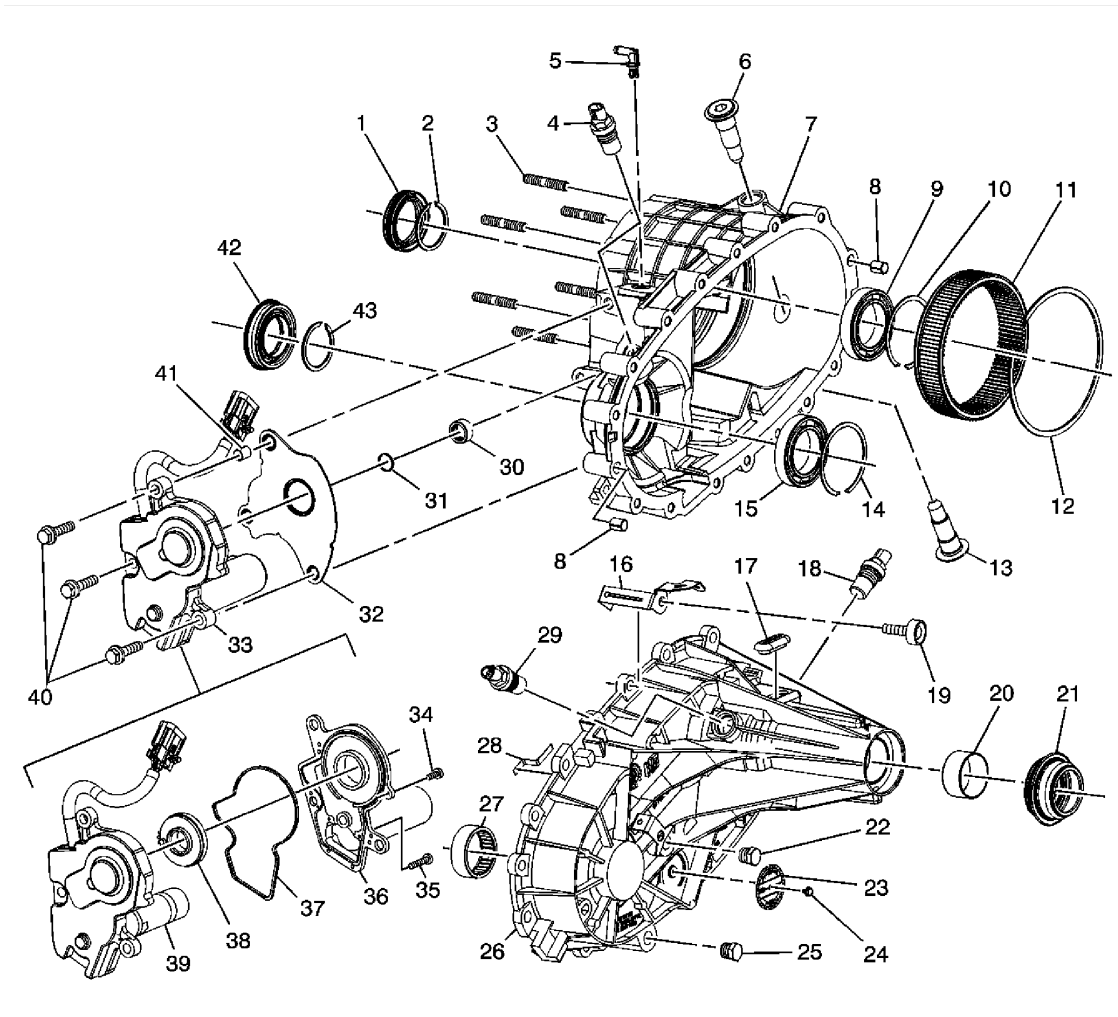

Fig. 16: Case Half Components Disassembled View
 Courtesy of GENERAL MOTORS CORP.

Callout	Component Name
1	Input Shaft Seal
2	Input Gear Bearing Outer Retaining Ring
3	Adapter Stud
4	Front Vehicle Speed Sensor
5	Vent
6	Clutch Lever Pivot Pin
7	Front Case Half
8	Location Pin
8	Location Pin
9	Input Gear Bearing
10	Input Gear Bearing Retaining Ring
11	Annulus Gear
12	Annulus Gear Retaining Ring

2007 Chevrolet Tahoe

2007 TRANSMISSION Transfer Case - NVG 246-NP8 - Avalanche, Escalade, Suburban, Tahoe & Yukon

13	Clutch Lever Pivot Pin
14	Front Output Shaft Bearing Retaining Ring
15	Front Output Shaft Front Bearing
16	Bracket
17	Access Hole Plug
18	Right Vehicle Speed Sensor
19	Case Half Bolt
20	Rear Bushing
21	Rear Output Shaft Seal
22	Fill Plug
23	ID Tag
24	ID Tag Screw
25	Drain Plug
26	Rear Case Half
27	Front Output Shaft Rear Bearing
28	Wear Clip
29	Left Vehicle Speed Sensor
30	Control Actuator Lever Bearing
31	Control Actuator Lever Retaining Ring
32	Actuator Encoder Motor Insulating Spacer
33	Actuator Encoder Motor
34	Housing Screw
35	Motor Cover Screw
36	Actuator Cover Plate
37	Actuator Seal
38	Range Select Position Sensor
39	Actuator Housing
40	Actuator Encoder Motor Bolt
41	Actuator Encoder Motor Location Pin
42	Front Output Shaft Seal
43	Front Output Shaft Bearing Retaining Ring

2007 Chevrolet Tahoe

2007 TRANSMISSION Transfer Case - NVG 246-NP8 - Avalanche, Escalade, Suburban, Tahoe & Yukon

17	Rear Output Shaft Speed Reluctor Wheel
18	Rear Output Shaft Rear Bearing Retaining Ring
19	Rear Output Shaft Rear Bearing Outer Retaining Ring
20	Rear Output Shaft Rear Bearing
21	Oil Pump Suction Pipe O-Ring Seal
22	Oil Pump Screen and Suction Pipe
23	Magnet
24	Driven Sprocket Retaining Ring
25	Driven Sprocket
26	Front Output Shaft Cup Plug
27	Front Output Shaft
28	Front Output Shaft Speed Reluctor Wheel
29	Clutch Lever
30	Control Actuator Lever
31	Range Fork
32	Shift Fork Pads
33	Shift Fork Shaft

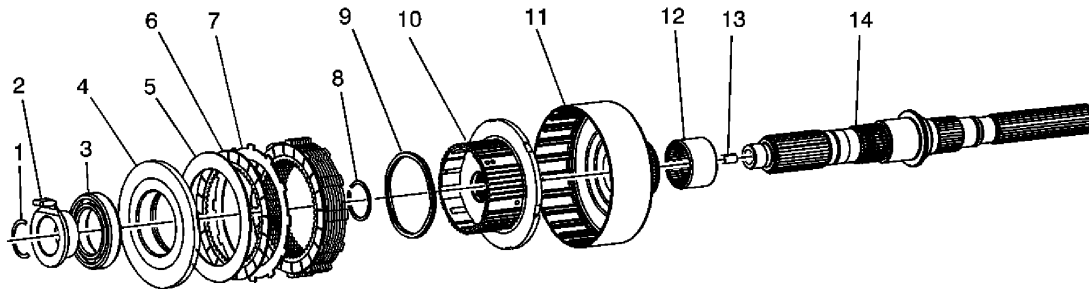

Fig. 18: Clutch Components

Courtesy of GENERAL MOTORS CORP.

Callout	Component Name
1	Clutch Retaining Ring
2	Clutch Bearing Inner Support
3	Clutch Apply Plate Bearing
4	Clutch Apply Plate
5	Shims
6	Clutch Inner Plate Friction
7	Clutch Outer Plate Steel
8	Clutch Hub Retaining Ring
9	Clutch Return Spring
10	Clutch Hub

2007 Chevrolet Tahoe

2007 TRANSMISSION Transfer Case - NVG 246-NP8 - Avalanche, Escalade, Suburban, Tahoe & Yukon

11	Clutch Housing
12	Clutch Housing Bearing
13	Oil Restrictor
14	Rear Output Shaft